

NOTICE!!

These documents have been scanned!

Do not place un-scanned documents beneath this notice!

Do not remove this notice from this file!

GPO Jacket No. 560-102
Print Order 61540
Rise Business Services, LLC
Job=AZ15 6/5/2019



Box Number= AZ15114



Claim Begin-End: AMC366287-AMC366287

1 Initial Receipt



AZ15114-11

AMC365609-AMC366287

**United States Department of the Interior
Bureau of Land Management**

BUSINESS & SUPPORT SVCS DIV
222 N CENTRAL AVE
PHOENIX, AZ 85004 -2203
Phone: (602) 417-9200

| | |
|---------|---------|
| Receipt | |
| No: | 1100820 |

| |
|--|
| Transaction #: 1139327 |
| Date of Transaction: 06/27/2005 |
| CUSTOMER: GOLDEN ROD GROUP 2 TWIN OAKS PL LAUREL,MS 39440 |

ENTERED IN COMPUTER
7/18/2005

| LINE # | QTY | DESCRIPTION | REMARKS | UNIT PRICE | TOTAL |
|---------------|------|--|---------|------------|-----------------|
| 1 | 1.00 | LOCATABLE MINERALS / MINING CLAIMS-NEW, UNADJUDI, ONE OR MORE AUTH NO'S / NEW MINING CLAIM LOCATION FEE \$25 (1993) CASES: AMC366287/\$25.00 | | - n/a - | 25.00 |
| 2 | 1.00 | LOCATABLE MINERALS / MINING CLAIMS-NEW, UNADJUDI, ONE OR MORE AUTH NO'S / NEW MINING CLAIM SVC CHG \$10 (1930) CASES: AMC366287/\$10.00 | | - n/a - | 10.00 |
| 3 | 1.00 | LOCATABLE MINERALS / MINING CLAIMS-NEW, UNADJUDI, ONE OR MORE AUTH NO'S / NEW MINING CLM MAINT FEE \$100(1993) CASES: AMC366287/\$100.00 | | - n/a - | 100.00 |
| TOTAL: | | | | | \$135.00 |

| PAYMENT INFORMATION | | | |
|---------------------|---------|---|----------------------|
| 1 | AMOUNT: | \$135.00 | POSTMARKED: N/A |
| | TYPE: | CASH | RECEIVED: 06/27/2005 |
| | NAME: | GOLDEN ROD GROUP 2 TWIN OAKS PL LAUREL MS 39440 | |

| |
|---------|
| REMARKS |
| |

This receipt was generated by the automated BLM Collections and Billing System and is a paper representation of a portion of the official electronic record contained therein.

NOTICE!!

These documents have been scanned!

Do not place un-scanned documents beneath this notice!

Do not remove this notice from this file!

GPO Jacket No. 560-102
Print Order 61540
Rise Business Services, LLC
Job=AZ15 6/5/2019



Box Number= AZ15114



Claim Begin-End: AMC366287-AMC366287

2 Correspondence



AZ15114-11

AMC365609-AMC366287

August 25, 2008

Amc 68526
Amc 366287

Bureau of Land Management
Attn: Amy Bunda
One North Central Avenue, Suite 800
Phoenix, Arizona 85004-4427

IN RE: AMC 68554 GOLDENROD, AMC 366287 GOLDENROD #2

Ms. Bunda:

In reference to our phone conversation last week, this letter is to request that you use a duplicate maintenance payment for Claim #68554. You said there is two duplicate fees, so please use one for this year's fees due. Please use the other duplicate fee that was paid for next year's maintenance fee for this claim. I believe you said the duplicate fees were paid 8-21-06 and 8-23-06. Also, may I please get a fax or letter to verify this for my file? Our fax number is 601-428-0253.

Enclosed is the \$125.00 maintenance fee for the other claim #366287. If there is any questions, feel free to call me at 601-433-7507 or 601-319-9118 for Greg Rustin.

Please make sure the mailing address on file for both claims (correspondence, etc.) is:
P. O. Box 4031, Laurel, Mississippi 39441

Thanks,

Regenia Rustin

Regenia Rustin
P. O. Box 4031
Laurel, MS 39441

PHOENIX, ARIZONA
2008 AUG 28 A 7:42

366287

ms Bunda:
Address never
changed —
Please change
now.
Thank you!



United States Department of the Interior



BUREAU OF LAND MANAGEMENT
Arizona State Office
One North Central Avenue, Suite 800
Phoenix, Arizona 85004-4427
www.blm.gov/az/

October 9, 2009

In Reply Refer To:
3800 (9330) AB
AMC68526

CERTIFIED MAIL – RETURN RECEIPT REQUESTED 7008 2810 0000 6281 4427

NOTICE

GOLDEN ROD GROUP LLC
~~2-TWIN OAKS PL PO 82463~~
LAUREL, MS ~~394409004~~
39441

This Notice Affects Those Claims
Shown in the Block Below.

AMC68554
GOLDEN ROD

Additional Fees Required

Your maintenance fee payment for the 2010 assessment year, in the amount of \$125.00 per claim, for the claims listed above, has been received.

In accordance with 30 U.S.C. 28j(c) and 74 FR 30959-30962 (2009), the maintenance fee for mining claims has increased from \$125.00 per claim to \$140.00 per claim. Insufficient payment of the annual maintenance fee for the 2010 assessment year is a curable defect. Therefore you are required to submit a supplemental payment in the amount of \$15.00 per claim within 30 days of receipt of this notice or your claim(s) will be declared forfeited.

Please include your Arizona Mining Claim (AMC) serial number(s) and claim name(s) when submitting the additional fees. If additional information is required, please contact

PHOENIX, ARIZONA

2009 NOV - 2 A 8: 18

RECEIVED
BLM AZ STATE OFFICE

366287

| | | | | |
|--|--|---|------------------------------|----------------|
| CONVERSATION RECORD | | | TIME 1000 | DATE 3/27/2015 |
| TYPE | <input type="checkbox"/> VISIT <input type="checkbox"/> CONFERENCE <input checked="" type="checkbox"/> TELEPHONE | <input type="checkbox"/> INCOMING <input checked="" type="checkbox"/> OUTGOING | LOCATION OF VISIT/CONFERENCE | |
| NAME OF PERSON(S) CONTACTED OR IN CONTACT WITH YOU | | ORGANIZATION (OFFICE, DEPT., BUREAU, ETC.) AMC 366287 | TELEPHONE NO. (601) 319-9118 | |

SUBJECT:

Talked to Greg Rustin about addresses for locators Brent Rustin and James Crane who had return to sender mailings due to invalid mailing addresses.

SUMMARY:

Greg Rustin informed us that the mailing addresses changed for Brent Rustin and James Crane. The updated address provided for Brent Rustin is now PO BOX 201 LAUREL MS, 39441. The updated mailing address provided for James Crane is now 562 E VIEW DR LAUREL 39443.

ACTION REQUIRED:

Updated the bad addresses in LR2000 with the provided updated addresses for AMC 366287.

| | | |
|---|-----------------------|-----------|
| NAME OF PERSON DOCUMENTING CONVERSATION | SIGNATURE | DATE |
| Robert Mattson | <i>Robert Mattson</i> | 3/27/2015 |

ACTION TAKEN:

| | | |
|-----------|-------|------|
| SIGNATURE | TITLE | DATE |
| | | |

NOTICE!!

These documents have been scanned!

Do not place un-scanned documents beneath this notice!

Do not remove this notice from this file!

GPO Jacket No. 560-102
Print Order 61540
Rise Business Services, LLC
Job=AZ15 6/5/2019



Box Number= AZ15114



Claim Begin-End: AMC366287-AMC366287

3 Transfers



AZ15114-11

AMC365609-AMC366287

**NO
DOCUMENTS
FOUND**

NO DOCUMENTS FOUND
NO DOCUMENTS FOUND

NOTICE!!

These documents have been scanned!

Do not place un-scanned documents beneath this notice!

Do not remove this notice from this file!

GPO Jacket No. 560-102
Print Order 61540
Rise Business Services, LLC
Job=AZ15 6/5/2019



Box Number= AZ15114



Claim Begin-End: AMC366287-AMC366287

4 Annual Filings



AZ15114-11

AMC365609-AMC366287

By Aug 1st 2018

HMC 68526
366287
401294
404917
412808
414462

416191
421090
422696
423218
423383
423384
423385

Maintenance Fee Payment

Claimant Name: Greg Rustin
Address P.O. Box 201
City Laurel State MS Zip 39941
Telephone (601) 319-9118
E-Mail N/A
Signature _____

___ Check here if this address is a change

423386
423387
423388
423389

| Line No | AMC number | Claim/Site Name | County Recorder Data (if available) | TWP | RNG | SEC |
|---------|------------|-----------------|-------------------------------------|-----|-----|---------|
| 1. | 416195 | Luke # 1 | Placer 20 Acres | 9N | 4W | 36 |
| 2. | 416196 | Luke # 2 | Placer 20 Acres | 9N | 4W | 35 & 36 |
| 3. | 416197 | Luke # 3 | Placer 20 Acres | 9N | 4W | 35 |
| 4. | 416198 | Luke # 4 | Placer 20 Acres | 9N | 4W | 35 |
| 5. | 416199 | Luke # 5 | Placer 20 Acres | 8N | 4W | 2 |
| 6. | 416200 | Luke # 6 | Placer 20 Acres | 8N | 4W | 2 |
| 7. | 416201 | Luke # 7 | Placer 20 Acres | 8N | 4W | 2 & 3 |
| 8. | 423306 | Luke # 8 | Placer 20 Acres | 9N | 4W | 36 |
| 9. | 423307 | Luke # 9 | Placer 20 Acres | 9N | 4W | 35 & 36 |
| 10. | 423308 | Luke # 10 | Placer 20 Acres | 9N | 4W | 35 |
| 11. | 423309 | Luke # 11 | Placer 20 Acres | 9N | 4W | 35 |
| 12. | 416202 | Scarlet #1 | Lode 20 Acres | 9N | 4W | 36 |
| 13. | 416203 | Scarlet # 2 | Lode 20 Acres | 9N | 4W | 36 |
| 14. | 416204 | Scarlet # 3 | Lode 20 Acres | 9N | 4W | 36 |
| 15. | 416205 | Scarlet # 4 | Lode 20 Acres | 9N | 4W | 36 |
| 16. | 416206 | Scarlet # 5 | Lode 20 Acres | 9N | 4W | 36 |
| 17. | 416207 | Scarlet # 6 | Lode 20 Acres | 9N | 4W | 36 |
| 18. | 416208 | Scarlet # 7 | Lode 20 Acres | 9N | 4W | 36 |
| 19. | 416209 | Scarlet # 8 | Lode 20 Acres | 9N | 4W | 36 |
| 20. | 416191 | Cort # 1 | Placer 20 Acres | 9N | 4W | 36 |
| 21. | 416192 | Cort # 2 | Placer 20 Acres | 9N | 4W | 35 & 36 |

List additional claims on Form MCF114

Bureau of Land Management
Arizona State Office
www.blm.gov/az/

Page 1

4230242

21

| | | | |
|------------------|------|--------------|-----------|
| No. of Claims: | 21 | X \$155.00 = | \$3255.00 |
| Check No: | 1048 | Init. | |
| Receipt No: | | | |
| For BLM Use Only | | | |

PHOENIX, ARIZONA

2018 AUG - 7 P 12:16

RECEIVED
BLM ARIZONA STATE OFFICE

AUG 09 2018
BY: RAM

Maintenance Fee Payment

Claimant Name: Greg Rustin
 Address P.O. Box 201
 City Laurel State MS Zip 39941
 Telephone (601) 319-9118
 E-Mail N/A
 Signature _____

Check here if this address is a change

423383
423384
423385

| Line No | AMC number | Claim/Site Name | County Recorder Data (if available) | TWP | RNG | SEC |
|---------|------------|-----------------|-------------------------------------|-----|-----|---------|
| 1. | 416193 J | Cort # 3 | Placer 20 acres | 9N | 4W | 35 |
| 2. | 416194 J | Cort # 4 | Placer 20 acres | 9N | 4W | 36 |
| 3. | 423313 ← | Cort # 5 | Placer 20 acres | 9N | 4W | 36 |
| 4. | 423304 J | Cort # 6 | Placer 20 acres | 9N | 4W | 35 & 36 |
| 5. | 423305 J | Cort # 7 | Lode 20 acres | 9N | 4W | 35 |
| 6. | | | | | | |
| 7. | | | | | | |
| 8. | | | | | | |
| 9. | | | | | | |
| 10. | | | | | | |
| 11. | | | | | | |
| 12. | | | | | | |
| 13. | | | | | | |
| 14. | | | | | | |
| 15. | | | | | | |
| 16. | | | | | | |
| 17. | | | | | | |
| 18. | | | | | | |
| 19. | | | | | | |
| 20. | | | | | | |

RECEIVED
 BLM AZ STATE OFFICE
 2018 AUG -7 P 12:16
 PHOENIX, ARIZONA

List additional claims on Form MCF114

Bureau of Land Management
 Arizona State Office
www.blm.gov/az/

5

| | |
|-------------------------|-------------------------------|
| No. of Claims: <u>5</u> | X \$155.00 = <u>\$ 775.00</u> |
| Check No: <u>1048</u> | Init. _____ |
| Receipt No: _____ | |
| For BLM Use Only | |

Claimant Name: Greg Rustin
 Address P. O. Box 201
 City Laurel State: MS Zip 39941
 Telephone (601) 319- 9118
 E-Mail N/A
 Signature *Greg Rustin*

Check here if this address is a change

| Line No | AMC number | Claim/Site Name | County Recorder Data (if available) | TWP | RNG | SEC |
|---------|------------|-----------------|-------------------------------------|-----|-----|-----|
| 1. | 68554 ← | Golden Rod # 1 | Placer 20 acres | 9N | 4W | 7 |
| 2. | 366287 ← | Golden Rod # 2 | Placer 160 acres | 9N | 4W | 7 |
| 3. | 401294 ← | Golden Rod #3 | Lode 20 acres | 9N | 4W | 7 |
| 4. | 404917 ↗ | Golden Rod # 4 | Lode 20 acres | 9N | 4W | 7 |
| 5. | 404918 | Golden Rod # 5 | Lode 20 acres | 9N | 4W | 7 |
| 6. | 404919 | Golden Rod # 6 | Lode 20 acres | 9N | 4W | 7 |
| 7. | 404920 | Golden Rod # 7 | Lode 20 | 9N | 4W | 7 |
| 8. | 404921 | Golden Rod # 8 | Lode 20 acres | 9N | 4W | 7 |
| 9. | 404922 ↓ | Golden Rod # 9 | Lode 20 acres | 9N | 4W | 7 |
| 10. | 404923 ↓ | Golden Rod # 10 | Lode 20 acres | 9N | 4W | 7 |
| 11. | 412815 ↗ | Golden Rod # 11 | Lode 20 acres | 9N | 4W | 8 |
| 12. | 412814 | Golden Rod # 12 | Lode 20 acres | 9N | 4W | 8 |
| 13. | 412813 | Golden Rod # 13 | Lode 20 acres | 9N | 4W | 8 |
| 14. | 412812 | Golden Rod # 14 | Lode 20 acres | 9N | 4W | 8 |
| 15. | 412811 | Golden Rod # 15 | Lode 20 acres | 9N | 4W | 8 |
| 16. | 412810 | Golden Rod # 16 | Lode 20 acres | 9N | 4W | 8 |
| 17. | 412809 ↓ | Golden Rod # 17 | Lode 20 acres | 9N | 4W | 8 |
| 18. | 412808 ↓ | Golden Rod # 18 | Lode 20 acres | 9N | 4W | 8 |
| 19. | 414462 ↗ | Golden Rod # 19 | Lode 20 acres | 9N | 4W | 8 |
| 20. | 414463 ↙ | Golden Rod # 20 | Lode 20 acres | 9N | 4W | 8 |
| | | | | | | |

List additional claims on Form MCF114

Bureau of Land Management
 Arizona State Office
www.blm.gov/az/

20

| |
|---|
| No. of Claims: <u>27</u> X \$155 = <u>\$4185.00</u> |
| Check No: <u>1048</u> - Init. _____ |
| Receipt No: _____ |
| For BLM Use Only |

RECEIVED
 BLM AZ STATE OFFICE
 2010 AUG - 7 P 12: 16
 PHOENIX, ARIZONA

Maintenance Fee Payment

Claimant Name: Greg Rustin
 Address P. O. Box 201
 City Laurel State MS Zip 39941
 Telephone (601) 319-9118
 E-Mail N/A
 Signature *Greg Rustin*

Check here if this address is a change

| Line No | AMC number | Claim/Site Name | County Recorder Data (if available) | TWP | RNG | SEC |
|---------|------------|-----------------|-------------------------------------|-----|-----|-------|
| 1. | 414464 | Golden Rod # 21 | Lode 20 acres | 9N | 4W | 8 |
| 2. | 414465 | Golden Rod # 22 | Lode 20 acres | 9N | 4W | 5 & 8 |
| 3. | 422696 | Golden Rod # 23 | Placer 20 acres | 9N | 4W | 6 |
| 4. | 422697 | Golden Rod # 24 | Lode 20 acres | 9N | 4W | 6 |
| 5. | 422698 | Golden Rod # 25 | Lode 20 acres | 9N | 4W | 6 |
| 6. | 421111 | Rideco No. 8 | Lode under 3 acre | 9N | 4W | 6 |
| 7. | | | | | | |
| 8. | | | | | | |
| 9. | | | | | | |
| 10. | | | | | | |
| 11. | | | | | | |
| 12. | | | | | | |
| 13. | | | | | | |
| 14. | | | | | | |
| 15. | | | | | | |
| 16. | | | | | | |
| 17. | | | | | | |
| 18. | | | | | | |
| 19. | | | | | | |
| 20. | | | | | | |

RECEIVED
 BLM AZ STATE OFFICE
 2018 AUG - 7 12:16
 PHOENIX ARIZONA

List additional claims on Form MCF114

Bureau of Land Management
 Arizona State Office
www.blm.gov/az/

(Handwritten mark)

| | | |
|-------------------------|-------------|-----------|
| No. of Claims: 6 | X \$155 = | \$ 930.00 |
| Check No: 1043 | Init. _____ | |
| Receipt No: _____ | | |
| For BLM Use Only | | |

| Page | # Claims | Amount |
|--------------------|------------------|------------------|
| # 1 | 21 Claims | \$ 3255.00 |
| # 2 | 5 Claims | \$ 775.00 |
| # 3 | 27 Claims | \$ 4185.00 |
| # 4 | 6 Claims | \$ 930.00 |
| Grand Total | 59 Claims | \$9145.00 |

RECEIVED
BLM AZ STATE OFFICE
2018 AUG - 7 P 12: 16
PHOENIX, ARIZONA

United States Department of the Interior
 Bureau of Land Management
 LANDS/RECREATION & PLANNING
 ONE N CENTRAL AVE
 PHOENIX, AZ 85004 -2203
 Phone: 602-417-9200

Receipt

No: 3107967

| | |
|---|--|
| Transaction #: 3199624 | |
| Date of Transaction: 08/21/2014 | |
| CUSTOMER: | |
| GREGORY RUSTIN PO BOX 201 LAUREL,MS 39441-0201 US | |

| LINE # | QTY | DESCRIPTION | REMARKS | UNIT PRICE | TOTAL |
|---------------|------|---|---------------------------|------------|-------------------|
| 1 | 1.00 | LOCATABLE MINERALS / MINING CLAIMS-NOT NEW-UNADJUD, ONE AUTH NO. ONLY / MINING-CLAIM MONEY RECEIVED CASES: AMC416195/\$9145.00 | MAINT FEE PYMNT (59) 2015 | - n/a - | 9145.00 |
| TOTAL: | | | | | \$9,145.00 |

| PAYMENT INFORMATION | | | |
|---------------------|-----------|--|------------------------|
| 1 | AMOUNT: | 9145.00 | POSTMARKED: 08/15/2014 |
| | TYPE: | CHECK | RECEIVED: 08/20/2014 |
| | CHECK NO: | 1038 | |
| | NAME: | GOLDENROD GROUP LLC 562 EASTVIEW DR LAUREL MS 39443 US | |

| |
|---------|
| REMARKS |
| |

This receipt was generated by the automated BLM Collections and Billing System and is a paper representation of a portion of the official electronic record contained therein.

RECEIVED
 BLM
 AZ STATE OFFICE
 2014 AUG -7 P 12:16
 PHOENIX, ARIZONA

GOLDENROD GROUP LLC

~~562 EASTVIEW DRIVE~~ P.O. 201
Laurel, MS 39443-5332 39441
Phone 601-319-9118

August 2, 2018

Bureau of Land Management
Arizona State Office
One North Central Avenue
Suite 800
Phoenix, AZ 85004-4427
Phone: (602) 417-9200

RECEIVED
BLM AZ STATE OFFICE
2018 AUG - 7 P 12: 19
PHOENIX, ARIZONA

Re: 20~~18~~¹⁹ Maintenance Fee Payment

Gentlemen:

2019

319145

Enclosed you will find payment for our 20~~18~~ maintenance requirements of \$ ~~500~~ for our placer and lode mining claims. Also enclosed is a Maintenance fee payment sheet showing all the claims with AMC #. If you have any questions you may call myself or ~~Michael Snyder 760-401-0530~~ if there is any issue whatsoever with this remittance.

Thank you for your prompt attention to this matter. - Greg 601 3199 118

Sincerely,

Greg Rustin
Goldenrod Group LLC.

Can you please verify All my AMC #s

Thanks Greg Rustin

User: myers
Office: LLAZ920000
System: Production

Form Buttons 508

- ▶ Logoff
- ▶ Switch User
- ▶ Help
- ▶ Print
- ▶ Reports
- ▶ Submit Help Ticket to CBS
- ▶ CBS Startup Page

Billings
▶ Print Bills

Collections
▶ Reprint Receipt
▶ Transfer/Reversal

Reversal Confirmation - Transfer

Edit Authorization Numbers Save Cancel

Login ID 6222
Entry Date 09/20/2018
Total Amount \$1,185.00

Original Order Items

| Line | Order# | AuthNos | TransDate | Action | Amount | CostCtr | R Org | BPD Year | Fund | FunctArea | V |
|------|---------|-----------|------------|-----------------------------|------------|------------|------------|----------|------------|------------------|---|
| 1 | 4345523 | AMC416195 | 08/30/2018 | MINING CLAIM MONEY RECEIVED | \$1,185.00 | LLAZ920000 | LLAZ920000 | 2018 | XXXL6500DP | L01130000.000000 | |

Order Items To Be Generated for Transfer

| Line | Order# | AuthNos | TransDate | Action | Amount | CostCtr | R Org | BPD Year | Fund | FunctArea | V |
|------|---------|-----------|-----------|-----------------------------|-------------|------------|------------|----------|------------|------------------|---|
| 1 | 4345523 | AMC416195 | 9/20/2018 | MINING CLAIM MONEY RECEIVED | \$-1,185.00 | LLAZ920000 | LLAZ920000 | 2018 | XXXL6500DP | L01130000.000000 | |
| 2 | 4345523 | AMC416195 | 9/20/2018 | MINING CLAIM MONEY RECEIVED | \$1,185.00 | LLAZ920000 | LLAZ920000 | 2018 | XXXL6500DP | L01130000.000000 | |

has be enabled for your account it will be the only method by which you will be able to login into BASS!

United States Department of the Interior
Bureau of Land Management
 DIV OF LANDS, MINRLS & ENERGY
 ONE N CENTRAL AVE
 PHOENIX, AZ 85004 -4427
 Phone: 602-417-9200

Receipt

No: 4230242

| | |
|--|--|
| Transaction #: 4345523 | |
| Date of Transaction: 08/08/2018 | |
| CUSTOMER: | |
| GREGORY RUSTIN PO BOX 201 LAUREL, MS 39441-0201 US | |

| LINE # | QTY | DESCRIPTION | REMARKS | UNIT PRICE | TOTAL |
|---------------|------|---|------------------|------------|-------------------|
| 1 | 1.00 | LOCATABLE MINERALS / MINING CLAIMS- NOT NEW-UNADJUD, ONE AUTH NO. ONLY / MINING CLAIM MONEY RECEIVED CASES: AMC416195/\$8060.00 | MAINT 2019/52 | - n/a - | 8060.00 |
| 2 | 1.00 | OVERPAYMENT / OVERPAYMENT OF FEES / OVERPAYMENT OF \$1.00 OR MORE | | 1185.00 | 1185.00 |
| TOTAL: | | | | | \$9,245.00 |

9145
 AND RETURN PROCESSED 10/11/2018. 3796 WZM/PC

| PAYMENT INFORMATION | | | |
|---------------------|-----------|--|----------------------|
| 1 | AMOUNT: | 100.00 | POSTMARKED: N/A |
| | TYPE: | CASH | RECEIVED: 08/08/2018 |
| | NAME: | RUSTIN, GREGORY PO BOX 201 LAUREL MS 39441-0201 US | |
| 2 | AMOUNT: | 9145.00 | POSTMARKED: N/A |
| | TYPE: | CHECK | RECEIVED: 08/08/2018 |
| | CHECK NO: | 1048 | |
| | NAME: | RUSTIN, GREGORY PO BOX 201 LAUREL MS 39441-0201 US | |

?

| |
|---------|
| REMARKS |
| |

This receipt was generated by the automated BLM Collections and Billing System and is a paper representation of a portion of the official electronic record contained therein.

| Claim Name | Serial Number | Lead Serial Number | Claimant Name | Mer | Twn | Rng | Sec | Subdiv | County | Geo State | Loc Date | Closed Date |
|------------|---------------|--------------------|----------------|-----|-------|-------|-----|--------|---------|-----------|------------|-------------|
| LUKE #1 | AMC416195 | AMC416191 | EDWARDS TRISH | 14 | 0090N | 0040W | 036 | SW | YAVAPAI | AZ | 06/03/2012 | |
| LUKE #1 | AMC416195 | AMC416191 | SEALEY RANDY | 14 | 0090N | 0040W | 036 | SW | YAVAPAI | AZ | 06/03/2012 | |
| LUKE #10 | AMC423388 | AMC423383 | SEALEY RANDY L | 14 | 0090N | 0040W | 035 | SE | YAVAPAI | AZ | 06/01/2013 | |
| LUKE #11 | AMC423389 | AMC423383 | SEALEY RANDY L | 14 | 0090N | 0040W | 035 | SE | YAVAPAI | AZ | 06/01/2013 | |
| LUKE #2 | AMC416196 | AMC416191 | EDWARDS TRISH | 14 | 0090N | 0040W | 035 | SE | YAVAPAI | AZ | 06/03/2012 | |
| LUKE #2 | AMC416196 | AMC416191 | EDWARDS TRISH | 14 | 0090N | 0040W | 036 | SW | YAVAPAI | AZ | 06/03/2012 | |
| LUKE #2 | AMC416196 | AMC416191 | SEALEY RANDY | 14 | 0090N | 0040W | 035 | SE | YAVAPAI | AZ | 06/03/2012 | |
| LUKE #2 | AMC416196 | AMC416191 | SEALEY RANDY | 14 | 0090N | 0040W | 036 | SW | YAVAPAI | AZ | 06/03/2012 | |
| LUKE #3 | AMC416197 | AMC416191 | EDWARDS TRISH | 14 | 0090N | 0040W | 035 | SE | YAVAPAI | AZ | 06/03/2012 | |
| LUKE #3 | AMC416197 | AMC416191 | SEALEY RANDY | 14 | 0090N | 0040W | 035 | SE | YAVAPAI | AZ | 06/03/2012 | |
| LUKE #4 | AMC416198 | AMC416191 | EDWARDS TRISH | 14 | 0090N | 0040W | 035 | SE | YAVAPAI | AZ | 06/03/2012 | |
| LUKE #4 | AMC416198 | AMC416191 | SEALEY RANDY | 14 | 0090N | 0040W | 035 | SE | YAVAPAI | AZ | 06/03/2012 | |
| LUKE #5 | AMC416199 | AMC416191 | SEALEY RANDY | 14 | 0080N | 0040W | 002 | NW | YAVAPAI | AZ | 06/03/2012 | |
| LUKE #6 | AMC416200 | AMC416191 | SEALEY RANDY | 14 | 0080N | 0040W | 002 | NW | YAVAPAI | AZ | 06/03/2012 | |
| LUKE #7 | AMC416201 | AMC416191 | SEALEY RANDY | 14 | 0080N | 0040W | 002 | NW | YAVAPAI | AZ | 06/03/2012 | |
| LUKE #7 | AMC416201 | AMC416191 | SEALEY RANDY | 14 | 0080N | 0040W | 003 | NE | YAVAPAI | AZ | 06/03/2012 | |
| LUKE #8 | AMC423386 | AMC423383 | SEALEY RANDY L | 14 | 0090N | 0040W | 036 | SW | YAVAPAI | AZ | 06/01/2013 | |
| LUKE #9 | AMC423387 | AMC423383 | SEALEY RANDY L | 14 | 0090N | 0040W | 035 | SE | YAVAPAI | AZ | 06/01/2013 | |
| LUKE #9 | AMC423387 | AMC423383 | SEALEY RANDY L | 14 | 0090N | 0040W | 036 | SW | YAVAPAI | AZ | 06/01/2013 | |

| Claim Name | Serial Number | Lead Serial Number | Claimant Name | Mer | Tw | Rng | Sec | Subdiv | County | Geo State | Loc Date | Closed Date |
|----------------|---------------|--------------------|--------------------|-----|-------|-------|-----|--------|---------|-----------|------------|-------------|
| CORT #1 | AMC416191 | AMC416191 | EDWARDS TRISH | 14 | 0090N | 0040W | 036 | SW | YAVAPAI | AZ | 06/03/2012 | |
| CORT #1 | AMC416191 | AMC416191 | SEALEY RANDY | 14 | 0090N | 0040W | 036 | SW | YAVAPAI | AZ | 06/03/2012 | |
| CORT #2 | AMC416192 | AMC416191 | EDWARDS TRISH | 14 | 0090N | 0040W | 035 | SE | YAVAPAI | AZ | 06/03/2012 | |
| CORT #2 | AMC416192 | AMC416191 | EDWARDS TRISH | 14 | 0090N | 0040W | 036 | SW | YAVAPAI | AZ | 06/03/2012 | |
| CORT #2 | AMC416192 | AMC416191 | SEALEY RANDY | 14 | 0090N | 0040W | 035 | SE | YAVAPAI | AZ | 06/03/2012 | |
| CORT #2 | AMC416192 | AMC416191 | SEALEY RANDY | 14 | 0090N | 0040W | 036 | SW | YAVAPAI | AZ | 06/03/2012 | |
| CORT #3 | AMC416193 | AMC416191 | EDWARDS TRISH | 14 | 0090N | 0040W | 035 | SE | YAVAPAI | AZ | 06/03/2012 | |
| CORT #3 | AMC416193 | AMC416191 | SEALEY RANDY | 14 | 0090N | 0040W | 035 | SE | YAVAPAI | AZ | 06/03/2012 | |
| CORT #4 | AMC416194 | AMC416191 | SEALEY RANDY | 14 | 0090N | 0040W | 036 | SW,SE | YAVAPAI | AZ | 06/03/2012 | |
| CORT #5 | AMC423383 | AMC423383 | SEALEY RANDY L | 14 | 0090N | 0040W | 036 | SW | YAVAPAI | AZ | 06/01/2013 | |
| CORT #6 | AMC423384 | AMC423383 | SEALEY RANDY L | 14 | 0090N | 0040W | 035 | SE | YAVAPAI | AZ | 06/01/2013 | |
| CORT #6 | AMC423384 | AMC423383 | SEALEY RANDY L | 14 | 0090N | 0040W | 036 | SW | YAVAPAI | AZ | 06/01/2013 | |
| CORT #7 | AMC423385 | AMC423383 | SEALEY RANDY L | 14 | 0090N | 0040W | 035 | SE | YAVAPAI | AZ | 06/01/2013 | |
| CORTEZ GOLD #2 | AMC428849 | AMC428848 | BUTTERFIELD ROBERT | 14 | 0110N | 0020E | 034 | SW | YAVAPAI | AZ | 05/01/2014 | |

Authorized Date10/11/2018

Instructions to Accounts AZ BLM REFUND \$100, TO GREGORY RUSTIN; FOR OVERPAYMENT
OF FEES, ON AMC416195, RECEIPT #4230242. RM

Login ID6222

Entry Date10/11/2018

Total Amount\$100.00

UNITED STATES
DEPARTMENT OF THE INTERIOR
BUREAU OF LAND MANAGEMENT
MAINTENANCE FEE PAYMENT

366287
08526
422696
416191

RECEIVED
2017 AUG 18 P 2:05
TULSA, OKLAHOMA

Remitter Name: Greg Rustin /Goldenrod LLC.

Mailing Address: P.O. Box 201

City, State, Zip: Laurel, MS 39441-0201

Check Here if Change of Address (X)

Goldenrod #2@gmail.com

The maintenance fee for the following claim(s)/site(s) applies to the assessment year **2017**.

421090
401294
404917
412808
414462

• **Placer Claims**

| <u>BLM Serial Number</u> | <u>Claim Name</u> | <u>Acreeage</u> |
|--------------------------|-------------------|-----------------|
| AMC366287 | GOLDEN #2 | 160 |
| AMC68554 | GOLDEN ROD | 20 |
| AMC422696 | GOLDENROD #23 | 20 |
| AMC416195 | LUKE #1 | 20 |
| AMC416196 | LUKE #2 | 20 |
| AMC416197 | LUKE #3 | 20 |
| AMC416198 | LUKE #4 | 20 |
| AMC416199 | LUKE #5 | 20 |
| AMC416200 | LUKE #6 | 20 |
| AMC416201 | LUKE #7 | 20 |
| AMC423306 | LUKE #8 | 20 |
| AMC423307 | LUKE #9 | 20 |
| AMC423308 | LUKE #10 | 20 |
| AMC423309 | LUKE #11 | 20 |
| AMC416191 | CORT #1 | 20 |
| AMC416192 | CORT #2 | 20 |
| AMC416193 | CORT #3 | 20 |
| AMC416194 | CORT #4 | 20 |
| AMC423313 | CORT #5 | 20 |
| AMC423304 | CORT #6 | 20 |

423386
423387
423388
423389
423383
423384

Total placer acreage = 540
Subtotal Placer Fee Due = \$ 4,185

Correct numbers email to Greg Rustin 9/1/17 UT

3946277

ENTERED
AUG 24 2017
BY: *RAW*

• Lode Claims

BLM Serial Number

Claim Name

| | |
|--------------------|---------------|
| AMC421111 - | RIDECO NO. 8 |
| AMC422697 J | GOLDENROD #24 |
| AMC422698 J | GOLDENROD #25 |
| AMC401294 - | GOLDEN ROD #3 |
| AMC404917 J | GOLDENROD #4 |
| AMC404918 | GOLDENROD #5 |
| AMC404919 | GOLDENROD #6 |
| AMC404920 | GOLDENROD #7 |
| AMC404921 | GOLDENROD #8 |
| AMC404922 | GOLDENROD #9 |
| AMC404923 J | GOLDENROD #10 |
| AMC412808 J | GOLDENROD #18 |
| AMC412809 | GOLDENROD #17 |
| AMC412810 | GOLDENROD #16 |
| AMC412811 | GOLDENROD #15 |
| AMC412812 | GOLDENROD #14 |
| AMC412813 | GOLDENROD #13 |
| AMC412814 | GOLDENROD #12 |
| AMC412815 J | GOLDENROD #11 |
| AMC414462 J | GOLDENROD #19 |
| AMC414463 | GOLDENROD #20 |
| AMC414464 | GOLDENROD #21 |
| AMC414465 J | GOLDENROD #22 |
| AMC416202 J | SCARLET #1 |
| AMC416203 | SCARLET #2 |
| AMC416204 | SCARLET #3 |
| AMC416205 | SCARLET #4 |
| AMC416206 | SCARLET #5 |
| AMC416207 | SCARLET #6 |
| AMC416208 | SCARLET #7 |
| AMC416209 J | SCARLET #8 |
| AMC423305 - 423385 | CORT #7 |

Total Lode Claims = 32 x \$155
 Subtotal Lode Fee Due = \$4,960

Total Due = \$9,145.00

RECEIVED
 2011 AUG 18 P 2:05
 GLENDALE, ARIZONA



FedEx carbon-neutral
envelope shipping

Align top of FedEx Express® shipping label here.

RT 278
ST 1.4
1 15:00
D 0750
08.18

ORIGIN ID: HBGA (601) 319-9118
GREGORY RUSTIN
64 WASLEY RD
LAUREL, MS 39441
UNITED STATES US

SHIP DATE: 17AUG17
ACTWGT: 0.10 LB
CAD: 006994217/SSFE1802

BILL CREDIT CARD

TO
BUREAU OF LAND MANAGEMENT
1 NORTH CENTRAL AVE

PHOENIX AZ 85004
(000) 000-0000 REF: DEPT:



TAK# 0201 7700 5458 6759

FRI - 18 AUG 3:00P
STANDARD OVERNIGHT
DSR
85004
AZ-US PHX

XH ZSYA



RECEIVED
BLM AZ STATE OFFICE
2017 AUG 18 P 2:00
PHOENIX, ARIZONA

Part # 1582971 2007 7449 6395 0018



Helping the environment.

When you use envelopes that are part of our FedEx carbon-neutral envelope shipping program, you're helping support sustainable projects like wind farms and reforestation. Our investments in these projects help neutralize the carbon emitted when shipping, all at no extra cost to you. Now that's a breath of fresh air.

See how FedEx connects the world in responsible and resourceful ways at **earthsmart.fedex.com**. Join our efforts by recycling this envelope.



Extremely Urgent

For FedEx Express® Shipments Only

Contents should be compatible with the container and packed securely. For shipping terms and conditions and our limits of liability, refer to the applicable FedEx Express shipping document, the current FedEx Service Guide, or conditions of carriage.

For more information on FedEx Express services, solutions, and shipping locations, go to **fedex.com**, or contact your nearest FedEx location.

© 2013 FedEx 155475/155476 REV 9/13

▼ Insert shipping document here.

United States Department of the Interior
Bureau of Land Management
 DIV OF LANDS, MINRLS & ENERGY
 ONE N CENTRAL AVE
 PHOENIX, AZ 85004 -4427
 Phone: 602-417-9200

Receipt

No: 3946277

| | |
|---|--|
| Transaction #: 4055955 | |
| Date of Transaction: 08/21/2017 | |
| CUSTOMER: | |
| GREGORY RUSTIN PO BOX 201 LAUREL,MS 39441-0201 US | |

| LINE # | QTY | DESCRIPTION | REMARKS | UNIT PRICE | TOTAL |
|---------------|------|---|------------------|------------|-------------------|
| 1 | 1.00 | LOCATABLE MINERALS / MINING CLAIMS- NOT NEW-UNADJUD,ONE AUTH NO. ONLY / MINING CLAIM MONEY RECEIVED CASES: AMC366287/\$9145.00 | MAINT 2018/32 | - n/a - | 9145.00 |
| TOTAL: | | | | | \$9,145.00 |

| PAYMENT INFORMATION | | | |
|---------------------|-----------|--|------------------------|
| 1 | AMOUNT: | 9145.00 | POSTMARKED: 08/17/2017 |
| | TYPE: | CHECK | RECEIVED: 08/18/2017 |
| | CHECK NO: | 6720301747 | |
| | NAME: | RUSTIN, GREGORY PO BOX 201 LAUREL MS 39441-0201 US | |

| |
|---------|
| REMARKS |
| |

This receipt was generated by the automated BLM Collections and Billing System and is a paper representation of a portion of the official electronic record contained therein.

AMC366287

Authorized Date07/13/2017

Instructions to Accounts AZ BLM REFUND \$1860.00 TO GOLDENROD GROUP LLC, FOR
OVERPMT OF 2016 M/FEES, ON AMC366287, RECEIPT
#3376036. THIS IS A SECOND ATTEMPT; PLEASE SEND THIS
TIME TO: PO BOX 201 LAUREL, MS 39441-0201. PB

Login ID5957

Entry Date07/13/2017

Total Amount\$1,860.00

THIS IS A SECOND ATTEMPT {Send to the PO Box address this time}

Refund Authorization Selection Grid

| <u>Line</u> | <u>Select</u> | <u>Transaction Number</u> | <u>Order Item ID</u> | <u>Trans Date</u> | <u>Fund</u> | <u>Cost Center</u> | <u>Available</u> | <u>To Authorize</u> | <u>Customer</u> | <u>Remitter</u> | <u>Serial Number</u> | <u>Bill Number</u> |
|-------------|--------------------------|---------------------------|----------------------|-------------------|-------------|--------------------|------------------|---------------------|---------------------|---------------------|----------------------|--------------------|
| 1 | <input type="checkbox"/> | 3474270 | 7364781 | 08/28/2015 | 15XL1109HF | LLAZ950000 | 7285.00 | 7285.00 | GOLDENROD GROUP LLC | GOLDENROD GROUP LLC | AMC68554 | |
| 2 | <input type="checkbox"/> | 3474270 | 8028260 | 02/06/2017 | XXXL6500DP | LLAZ931000 | 1860.00 | 1860.00 | GOLDENROD GROUP LLC | GOLDENROD GROUP LLC | AMC366287 | |

AZ BLM REFUND \$1860.00 TO GOLDENROD GROUP LLC, FOR OVERPMT OF 2016 M/FEEs, ON AMC366287, RECEIPT #3376036. THIS IS A SECOND ATTEMPT; PLEASE SEND THIS TIME TO: PO BOX 201 LAUREL, MS 39441-0201. PB 602-417-9360.

pan

DLA

United States Department of the Interior
Bureau of Land Management
 LANDS/RECREATION & PLANNING
 ONE N CENTRAL AVE
 PHOENIX, AZ 85004 -2203
 Phone:

Receipt

No: 3376036

Transaction #: 3474270
 Date of Transaction: 08/25/2015

CUSTOMER:

GOLDENROD GROUP LLC
 562 EASTVIEW DR
 LAUREL, MS 39443-5332 US

*DIFFERENT ADDRESS
 IN SYSTEM*

| LINE # | QTY | DESCRIPTION | REMARKS | UNIT PRICE | TOTAL |
|---------------|------|---|---------------------------|------------|-------------------|
| 1 | 1.00 | LOCATABLE MINERALS / MINING CLAIMS-NOT NEW-UNADJUD, ONE AUTH NO. ONLY / MINING CLAIM MONEY RECEIVED CASES: AMC366287/\$9145.00 | MAINT FEE PYMNT - 32 2016 | - n/a - | 9145.00 |
| TOTAL: | | | | | \$9,145.00 |

| PAYMENT INFORMATION | | | | | |
|---------------------|-----------|---|-------------|------------|--|
| 1 | AMOUNT: | 9145.00 | POSTMARKED: | 08/19/2015 | |
| | TYPE: | CHECK | RECEIVED: | 08/24/2015 | |
| | CHECK NO: | 1048 | | | |
| | NAME: | GOLDENROD GROUP LLC 562 EASTVIEW DR LAUREL MS 39443-5332 US | | | |

REMARKS

This receipt was generated by the automated BLM Collections and Billing System and is a paper representation of a portion of the official electronic record contained therein.

3:20 pm
7/11/17 I was able to reach Greg Austin @ 601-319-9118
 He said to use PO Box 201 Laurel, MS 39441 for the ck. *ps.*
 They moved from Eastview Dr. *ps*

7/13/2017 2nd ATTEMPT →
 Request to send to a PO Box address on file *ps*
 PO Box 201
 Laurel, MS 39441-0201

\$ 1,860 to be Returned

(see Email MSEA dated 7-12-2017)



Brown, Pauline <paulinebrown@blm.gov>

Address change

2 messages

Frank Dykes <goldenrodaz@gmail.com>
To: paulinebrown@blm.gov

Wed, Jul 12, 2017 at 9:00 AM

#3376036

Refile new address

Inv# 3376036 for over payment

Golden Rod Group
P.O.Box 201
Laurel, MS 39441
GoldenrodAZ@gmail.com

Sent from my iPad

Brown, Pauline <paulinebrown@blm.gov>
To: Frank Dykes <goldenrodaz@gmail.com>

Wed, Jul 12, 2017 at 10:10 AM

Thank you for the address confirmation; I will update our records.

Regards,

[Quoted text hidden]

--

PAULINE BROWN**LAND LAW EXAMINER**BUREAU OF LAND MANAGEMENT
ARIZONA STATE OFFICE
ONE NORTH CENTRAL AVE, STE 800
PHOENIX, AZ 85004-4427

OFFICE: (602) 417-9360

FAX: (602) 417-9490

paulinebrown@blm.govwww.blm.gov/az<https://www.facebook.com/BLMArizona>

Customer Name Update Screen

System ID:MC

Name:

Proprietor #: Renumber To:

Category:

Address:

City:

State:

Zip:

- UNDELIVERABLE
- No Annual Reminders

Email:

Phone:

**DEPARTMENT OF THE INTERIOR
BUREAU OF LAND MANAGEMENT
MINING CLAIMS**

(LIVE) Serial Register Page

Run Date/Time: 07/13/2017 08:52 AM

Page 1 of 1

01 10-21-1976;090STAT0090;43USC1744

Case Type 384201: PLACER CLAIM

Claim Name: GOLDEN #2

Commodity :

Case Disposition: ACTIVE

Required Maintenance Fee: \$1,240.00

Total Acres

160.000

Serial Number

AMC366287

Lead File Number

AMC366287

Name & Address

Int Rel

| | | | |
|-------------------------------------|-----------------|----------------------------|----------|
| ROSSER JANICE | 1204 E HOLLY ST | ELLISVILLE, MS 39437-2824 | CLAIMANT |
| RUSTIN BILL E | 186 JORDAN DR | LAUREL, MS 39443-2649 | CLAIMANT |
| CRANE JAMES | 562 EASTVIEW DR | LAUREL, MS 39443-5332 | CLAIMANT |
| RUSTIN GREG FOR GOLDENROD GROUP LLC | PO BOX 201 | LAUREL, MS 39441-0201 | CLAIMANT |
| RUSTIN DANIEL | PO BOX 63 | LAUREL, MS 39441-0063 | CLAIMANT |
| HALL JAMES | PO BOX 841 | BAY SPRINGS, MS 39422-0841 | CLAIMANT |
| RUSTIN BRENT | PO BOX 201 | LAUREL, MS 39441-0201 | CLAIMANT |
| UPSHAW AMY | PO BOX 63 | LAUREL, MS 39441-0063 | CLAIMANT |

Mer Twp Rng Sec
14 0090N 0040W 007

Quadrant
NE

District/Field Office
HASSAYAMPA FO

County
YAVAPAI

| Act Date | Code | Action | Action Remarks | Receipt Number |
|-----------------|-------------|-----------------------------|------------------------|-----------------------|
| 06/21/2005 | 403 | LOCATION DATE | | |
| 06/27/2005 | 395 | RECORDATION NOTICE RECD | 1 | 1100820 |
| 08/18/2016 | 782 | MAINTENANCE FEE PAYMENT | 2017;\$1240 | 3635104 |
| 08/24/2015 | 782 | MAINTENANCE FEE PAYMENT | 2016;\$1240 | 3376036 |
| 08/20/2014 | 782 | MAINTENANCE FEE PAYMENT | 2015;\$1240 | 3107967 |
| 08/26/2013 | 682 | MAINTENANCE FEE/\$140 | 2014;\$1120 | 2865816 |
| 08/31/2012 | 682 | MAINTENANCE FEE/\$140 | 2013;\$1120 | 2648035 |
| 08/23/2011 | 682 | MAINTENANCE FEE/\$140 | 2012 | 2412372 |
| 08/18/2010 | 682 | MAINTENANCE FEE/\$140 | 2011 | 2193666 |
| 08/25/2009 | 682 | MAINTENANCE FEE/\$140 | 2010 | 1993414 |
| 08/28/2008 | 582 | MAINTENANCE FEE/\$125 | 2009 | 1776798 |
| 08/23/2006 | 582 | MAINTENANCE FEE/\$125 | 2008 | 1341680 |
| 08/21/2006 | 582 | MAINTENANCE FEE/\$125 | 2007 | 1339312 |
| 08/26/2005 | 582 | MAINTENANCE FEE/\$125 | 2006 | 1141494 |
| 06/27/2005 | 484 | LOCATION YEAR / MAINTENANCE | 2005 | 1100820 |
| 07/13/2017 | 379 | REFUND AUTHORIZED | \$1860;OVERPMT 2ND TRY | 3376036 |
| 10/05/2015 | 379 | REFUND AUTHORIZED | \$1860;OVERPAYMENT | 3376036 |
| 05/02/2006 | 669 | LAND STATUS CHECKED | | |
| 01/25/2006 | 669 | LAND STATUS CHECKED | | |
| 06/27/2005 | 404 | COUNTY RECORDATION | 0;4279;482 | |
| 06/27/2005 | 501 | ACCT ADV IN LEAD FILE | AMC366287; | |

Line Nr Remarks

**NO WARRANTY IS MADE BY BLM
FOR USE OF THE DATA FOR
PURPOSES NOT INTENDED BY BLM**

416191
 423383
 68526
 366287
 401294
 404917

412808
 414462
 422696
 421090

Maintenance Fee Payment

Claimant Name: Greg Rustin
 Address P.O. Box 201
 City Laurel State MS Zip 39941
 Telephone (601) 319-9118 *39441*
 E-Mail N/A
 Signature _____

RECEIVED
 BLM AZ STATE OFFICE
 2016 AUG 18 P 4:11
 PHOENIX, ARIZONA

Check here if this address is a change

List additional claims on Form

| Line No | AMC number | Claim/Site Name | County Recorder Data (if available) | TWP | RANGE | SECTION |
|------------------|------------|-----------------|-------------------------------------|-----|-------|---------|
| 1. | 416195 | Lake # 1 ✓ | Placer 20 Acres | 9N | 4W | 36 |
| 2. | 416196 | Lake # 2 ✓ | Placer 20 Acres | 9N | 4W | 35 & 36 |
| 3. | 416197 | Lake # 3 ✓ | Placer 20 Acres | 9N | 4W | 35 |
| 4. | 416198 | Lake # 4 ✓ | Placer 20 Acres | 9N | 4W | 35 |
| 5. | 416199 | Lake # 5 ✓ | Placer 20 Acres | 8N | 4W | 2 |
| 6. | 416200 | Lake # 6 ✓ | Placer 20 Acres | 8N | 4W | 2 |
| 7. | 416201 | Lake # 7 ✓ | Placer 20 Acres | 8N | 4W | 2 & 3 |
| 8. <i>423386</i> | 423306 | Lake # 8 ✓ | Placer 20 Acres | 9N | 4W | 36 |
| 9. <i>387</i> | 423307 | Lake # 9 ✓ | Placer 20 Acres | 9N | 4W | 35 & 36 |
| 10. <i>388</i> | 423308 | Lake # 10 ✓ | Placer 20 Acres | 9N | 4W | 35 |
| 11. <i>389</i> | 423309 | Lake # 11 ✓ | Placer 20 Acres | 9N | 4W | 35 |
| 12. | 416202 | Scarlet #1 ✓ | Lode 20 Acres | 9N | 4W | 36 |
| 13. | 416203 | Scarlet #2 ✓ | Lode 20 Acres | 9N | 4W | 36 |
| 14. | 416204 | Scarlet #3 ✓ | Lode 20 Acres | 9N | 4W | 36 |
| 15. | 416205 | Scarlet #4 ✓ | Lode 20 Acres | 9N | 4W | 36 |
| 16. | 416206 | Scarlet #5 ✓ | Lode 20 Acres | 9N | 4W | 36 |
| 17. | 416207 | Scarlet #6 ✓ | Lode 20 Acres | 9N | 4W | 36 |
| 18. | 416208 | Scarlet #7 ✓ | Lode 20 Acres | 9N | 4W | 36 |
| 19. | 416209 | Scarlet #8 ✓ | Lode 20 Acres | 9N | 4W | 36 |
| 20. | 416191 | Cort # 1 ✓ | Placer 20 Acres | 9N | 4W | 36 |
| 21. | 416192 | Cort # 2 ✓ | Placer 20 Acres | 9N | 4W | 35 & 36 |

MCF114

No. of Claims: 21 X \$155.00 = \$3255.00
 Check No. CC Init. A.R.
 Receipt No. 3635704
 For BLM Use Only

Bureau of Land Management
 Arizona State Office
www.blm.gov/az/

INTERED
 AUG 22 2016
 BY: RAM

RECEIVED
BLM AZ STATE OFFICE
2018 AUG 18 P 12:41
PHOENIX, ARIZONA

Maintenance Fee Payment

Claimant Name: Greg Rustin
 Address P.O. Box 201
 City Laurel State MS Zip 39941
 Telephone (601) 319-9118
 E-Mail N/A
 Signature _____

Check here if this address is a change

List additional claims on Form

| Line No | AMC number | Claim/Site Name | County Recorder Data (if available) | TWP | RNG | SEC |
|----------------------|---------------------|-----------------------|-------------------------------------|-----|-----|---------|
| 1. | 416193 \checkmark | Cort # 3 \checkmark | Placer 20 acres | 9N | 4W | 35 |
| 2. | 416194 \checkmark | Cort # 4 \checkmark | Placer 20 acres | 9N | 4W | 36 |
| 3. 423383 | 423313 | Cort # 5 \checkmark | Placer 20 acres | 9N | 4W | 36 |
| 4. 423384 | 423304 \checkmark | Cort # 6 \checkmark | Placer 20 acres | 9N | 4W | 35 & 36 |
| 5. 423385 | 423305 \checkmark | Cort # 7 \checkmark | Lode 20 acres | 9N | 4W | 35 |
| 6. | | | | | | |
| 7. | | | | | | |
| 8. | | | | | | |
| 9. | | | | | | |
| 10. | | | | | | |
| 11. | | | | | | |
| 12. | | | | | | |
| 13. | | | | | | |
| 14. | | | | | | |
| 15. | | | | | | |
| 16. | | | | | | |
| 17. | | | | | | |
| 18. | | | | | | |
| 19. | | | | | | |
| 20. | | | | | | |

MCF114

No. of Claims: 5 X \$155.00 = \$775.00
 Check No: Ce Ce Init: AR
 Receipt No: 3635104
 For BLM Use Only

Bureau of Land Management
 Arizona State Office
www.blm.gov/az/

RECEIVED
BLM AZ STATE OFFICE
2018 AUG 18 P 12:41
PHOENIX, ARIZONA

Claimant Name: Greg Rustin
 Address P. O. Box 201
 City Laurel State: MS Zip 39941
 Telephone (601) 319-9118
 E-Mail N/A
 Signature _____

| Line No | AMC number | Claim/Site Name | County Recorder Data (if available) | TWP | RNG | SEC |
|---------|------------|------------------|-------------------------------------|-----|-----|-----|
| 1. | 68554 | Golden Rod #1 ✓ | Placer 20 acres | 9N | 4W | 7 |
| 2. | 366287 | Golden Rod #2 ✓ | Placer 160 acres | 9N | 4W | 7 |
| 3. | 401294 | Golden Rod #3 ✓ | Lode 20 acres | 9N | 4W | 7 |
| 4. | 404917 | Golden Rod #4 ✓ | Lode 20 acres | 9N | 4W | 7 |
| 5. | 404918 | Golden Rod #5 ✓ | Lode 20 acres | 9N | 4W | 7 |
| 6. | 404919 | Golden Rod #6 ✓ | Lode 20 acres | 9N | 4W | 7 |
| 7. | 404920 | Golden Rod #7 ✓ | Lode 20 | 9N | 4W | 7 |
| 8. | 404921 | Golden Rod #8 ✓ | Lode 20 acres | 9N | 4W | 7 |
| 9. | 404922 | Golden Rod #9 ✓ | Lode 20 acres | 9N | 4W | 7 |
| 10. | 404923 | Golden Rod #10 ✓ | Lode 20 acres | 9N | 4W | 7 |
| 11. | 412815 | Golden Rod #11 ✓ | Lode 20 acres | 9N | 4W | 8 |
| 12. | 412814 | Golden Rod #12 ✓ | Lode 20 acres | 9N | 4W | 8 |
| 13. | 412813 | Golden Rod #13 ✓ | Lode 20 acres | 9N | 4W | 8 |
| 14. | 412812 | Golden Rod #14 ✓ | Lode 20 acres | 9N | 4W | 8 |
| 15. | 412811 | Golden Rod #15 ✓ | Lode 20 acres | 9N | 4W | 8 |
| 16. | 412810 | Golden Rod #16 ✓ | Lode 20 acres | 9N | 4W | 8 |
| 17. | 412809 | Golden Rod #17 ✓ | Lode 20 acres | 9N | 4W | 8 |
| 18. | 412808 | Golden Rod #18 ✓ | Lode 20 acres | 9N | 4W | 8 |
| 19. | 414462 | Golden Rod #19 ✓ | Lode 20 acres | 9N | 4W | 8 |
| 20. | 414463 | Golden Rod #20 ✓ | Lode 20 acres | 9N | 4W | 8 |

Check here if this address is a change

List additional claims on Form MCF114

No. of Claims: 27 X \$155 = \$4185.00
 Check No: Cela Init. AR
 Receipt No: 3635104
 For BLM Use Only

Bureau of Land Management
 Arizona State Office
www.blm.gov/az/

RECEIVED
 BLM AZ STATE OFFICE
 2018 AUG 18 P 12:41
 PHOENIX, ARIZONA

Maintenance Fee Payment

Claimant Name: Greg Rustin
 Address P. O. Box 201
 City Laurel State MS Zip 39941
 Telephone (601) 319-9118
 E-Mail N/A
 Signature _____

| Line No | AMC number | Claim/Site Name | County Recorder Data (if available) | TWP | RNG | SEC |
|---------|------------|-------------------|-------------------------------------|-----|-----|-------|
| 1. | 414464 ✓ | Golden Rod # 21 ✓ | Lode 20 acres | 9N | 4W | 8 |
| 2. | 414465 ✓ | Golden Rod # 22 ✓ | Lode 20 acres | 9N | 4W | 5 & 8 |
| 3. | 422696 ✓ | Golden Rod # 23 ✓ | Placer 20 acres | 9N | 4W | 6 |
| 4. | 422697 ✓ | Golden Rod # 24 ✓ | Lode 20 acres | 9N | 4W | 6 |
| 5. | 422698 ✓ | Golden Rod # 25 ✓ | Lode 20 acres | 9N | 4W | 6 |
| 6. | 421111 - | Rideco No. 8 ✓ | Lode under 3 acre | 9N | 4W | 6 |
| 7. | | | | | | |
| 8. | | | | | | |
| 9. | | | | | | |
| 10. | | | | | | |
| 11. | | | | | | |
| 12. | | | | | | |
| 13. | | | | | | |
| 14. | | | | | | |
| 15. | | | | | | |
| 16. | | | | | | |
| 17. | | | | | | |
| 18. | | | | | | |
| 19. | | | | | | |
| 20. | | | | | | |

Check here if this address is a change

List additional claims on Form MCF114

| | |
|----------------------------|----------------------------|
| No. of Claims: <u>6</u> | X \$155 = \$ <u>930.00</u> |
| Check No: <u>CC</u> | Init: <u>AR</u> |
| Receipt No: <u>3635104</u> | |
| For BLM Use Only | |

Bureau of Land Management
 Arizona State Office
www.blm.gov/az/



Frank Dykes <hhairllc@gmail.com>

page 5
1 message

Congresspaul@aol.com <Congresspaul@aol.com>
To: hhairllc@gmail.com

Fri, Jul 29, 2016 at 9:55 AM

| Page | # Claims | Amount |
|--------------------|-------------------------|------------------|
| # 1 | 21 Claims | \$ 3255.00 |
| # 2 | 5 Claims | \$ 775.00 |
| # 3 | 27 Claims 20 | \$ 4185.00 |
| # 4 | 6 Claims | \$ 930.00 |
| Grand Total | 59 Claims | \$9145.00 |

RECEIVED
 BLM AZ STATE OFFICE
 2016 AUG 18 P 12:41
 PHOENIX, ARIZONA

**Greg Rustin
P.O.Box 201
Laurel, MS 39441**

**Bureau of Land Management
Arizona State Office
One North Central Avenue, Suite 800
Phoenix, AZ 85004-4427**

RECEIVED
BLM AZ STATE OFFICE
2015 AUG 18 P 12:40
PHOENIX, ARIZONA

100% Recycled fiber
80% Post-Consumer

Extremely Urgent

Visit **ups.com**® or call **1-800-PICK-UPS**® (1-800-742-5877) to schedule a pickup or find a drop off location near you.

Domestic Shipments

- To qualify for the Letter rate, UPS Express Envelopes may only contain correspondence, urgent documents, and/or electronic media, and must weigh 8 oz. or less. UPS Express Envelopes containing items other than those listed or weighing more than 8 oz. will be billed by weight.

International Shipments

- The UPS Express Envelope may be used only if value. Certain countries consider electronic mail. Visit ups.com/ImportExport to verify if your shipment is eligible for international shipping.
- To qualify for the Letter rate, the UPS Express Envelope must weigh 8 oz. or less.

Note: Express Envelopes are not recommended for containing sensitive personal information or drugs or cash equivalent.

RUSTIN METAL BLDGS AND CONSTRUCTION 0.1 LBS LTR 1 OF 1
6016499949
318 EAST 18TH ST
LAUREL MS 39441

SHIP TO:
ARIZONA STATE OFFICE
BUREAU OF LAND MANAGEMENT
SUITE 800
ONE NORTH CENTRAL AVE
PHOENIX AZ 85004

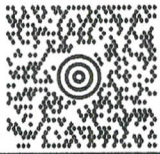

AZ 850 9-10



UPS 2ND DAY AIR

TRACKING #: 1Z 86V 913 35 9095 1199

2



BILLING: P/P
SIGNATURE REQUIRED

Reference No. 1: 636069624519270379

XOL 16.07.34

NV45 78.0A 07/2016



Do not use this envelope for:
UPS Ground
UPS Standard
UPS 2nd Day Select®
Idwide Expedited®

Apply shipping documents on this side.

This envelope is for use with the following services:
UPS Next Day Air®
UPS Worldwide Express™
UPS 2nd Day Air®

International Shipping Notice - Carriage hereunder may be subject to the rules relating to liability and other terms and/or conditions established by the Convention for the Unification of Certain Rules Relating to International Carriage by Air (the "Warsaw Convention") and/or the Convention on the Contract for the International Carriage of Goods by Road (the "CMR Convention"). These commodities, technology or software were exported from the U.S. in accordance with the Export Administration Regulations. Diversion contrary to U.S. law prohibited.

Serving you for more than 100 years
United Parcel Service.



010195101 4/14 PAC United Parcel Service

RECEIVED
BLM AZ STATE OFFICE
2016 AUG 18 P 12:40
PHOENIX, ARIZONA

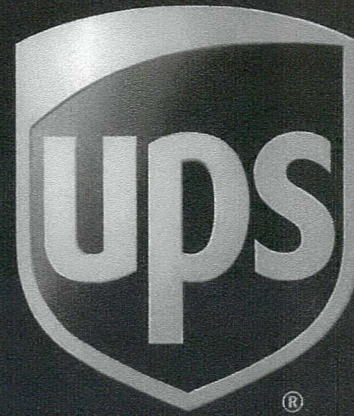

1 N CENTRAL AVE
STE 800
PHOENIX AZ 85004-4414
R: PURPLE S: ORANGE I: 44D
0903-4000
1Z85V913359095 1199
US 8501 HPPS 18 04 28 2016

Express Envelope

United States Department of the Interior
Bureau of Land Management
 DIV OF LANDS, MINRLS & ENERGY
 ONE N CENTRAL AVE
 PHOENIX, AZ 85004 -4427
 Phone: 602-417-9200

Receipt

No: 3635104

| | |
|---|--|
| Transaction #: 3738943 | |
| Date of Transaction: 08/19/2016 | |
| CUSTOMER: | |
| GREGORY RUSTIN PO BOX 201 LAUREL,MS 39441-0201 US | |

| LINE # | QTY | DESCRIPTION | REMARKS | UNIT PRICE | TOTAL |
|---------------|------|---|---|------------|-------------------|
| 1 | 1.00 | LOCATABLE MINERALS / MINING CLAIMS- NOT NEW-UNADJUD,ONE AUTH NO. ONLY / MINING CLAIM MONEY RECEIVED CASES: AMC416195/\$9145.00 | MAINT FEE 2017 - 59 52 | - n/a - | 9145.00 |
| TOTAL: | | | | | \$9,145.00 |

| PAYMENT INFORMATION | | | |
|---------------------|-----------|--|----------------------|
| 1 | AMOUNT: | 9145.00 | POSTMARKED: N/A |
| | TYPE: | CHECK | RECEIVED: 08/18/2016 |
| | CHECK NO: | 6717401378 | |
| | NAME: | RUSTIN, GREGORY D PO BOX 201 LAUREL MS 39441-0201 US | |

| |
|---------|
| REMARKS |
| |

This receipt was generated by the automated BLM Collections and Billing System and is a paper representation of a portion of the official electronic record contained therein.

United States Department of the Interior
Bureau of Land Management
 LANDS/RECREATION & PLANNING
 ONE N CENTRAL AVE
 PHOENIX, AZ 85004 -2203
 Phone: 602-417-9200

Receipt

No: 3376036

| | |
|--|--|
| Transaction #: 3474270 | |
| Date of Transaction: 08/25/2015 | |
| CUSTOMER: | |
| GOLDENROD GROUP LLC 562 EASTVIEW DR LAUREL, MS 39443-5332 US | |

| LINE # | QTY | DESCRIPTION | REMARKS | UNIT PRICE | TOTAL |
|---------------|------|---|---------------------------|------------|-------------------|
| 1 | 1.00 | LOCATABLE MINERALS / MINING CLAIMS-NOT NEW-UNADJUD, ONE AUTH NO. ONLY / MINING CLAIM MONEY RECEIVED CASES: AMC366287/\$9145.00 | MAINT FEE PYMNT - 32 2016 | - n/a - | 9145.00 |
| TOTAL: | | | | | \$9,145.00 |

\$1860.00 REFUNDED

| PAYMENT INFORMATION | | | |
|---------------------|-----------|---|------------------------|
| 1 | AMOUNT: | 9145.00 | POSTMARKED: 08/19/2015 |
| | TYPE: | CHECK | RECEIVED: 08/24/2015 |
| | CHECK NO: | 1048 | |
| | NAME: | GOLDENROD GROUP LLC 562 EASTVIEW DR LAUREL MS 39443-5332 US | |

| |
|---------|
| REMARKS |
| |

This receipt was generated by the automated BLM Collections and Billing System and is a paper representation of a portion of the official electronic record contained therein.

+ 7285 earned
\$ 1860 Refunded
 No Refund shows
 392 for \$1860 still on claim
 \$1860 REFUNDED ON 3 DEC 15. LR

Order Detail

[Close](#)

Transaction ID 3474270
 Order Type A
 Order Status P
 Order Date 08/25/2015
 Login ID 4268
 Login ahouston

Receive Date 08/25/2015
 Receipt ID 3376036
 Reference Transaction
 Last Updated By 4268
 Last Update User ahouston
 Last Update Date 8/25/15 11:15

Customer ID
 First Name
 Middle Initial
 Last Name
 Company GOLDENROD GROUP LLC

Address 1562 EASTVIEW DR
 Address 2
 City LAUREL State MS Zip -
 Country US
 Phone

Assignor ID
 First Name
 Middle Initial
 Last Name
 Company
 AR flag

Historical Order Number

Order Items

| OI | TranID | XferOI | OrderID | Login | OI-Date | Type | Qty | UnitPrice | Total | BillNumber | BillLine | BIID | CostCtr | ReptOrg | WBS | Commodity | Subject | Action | ActionCode | Bpd | ye |
|----|---------|---------|---------|----------|------------|------|-------|-----------|----------|------------|----------|------|------------|------------|-----|-----------|---------|-----------------------------|------------|------|----|
| 1 | 7355133 | | 3474270 | ahouston | 08/25/2015 | C | 1.00 | 0.00 | 9145.00 | | | | LLAZ931000 | LLAZ931000 | | LOCA | LMMC | MINING CLAIM MONEY RECEIVED | 9532 | 2015 | XX |
| 2 | 7364780 | 7355133 | 3474270 | LR2KMCII | 08/28/2015 | T | 0.80 | 0.00 | -7285.00 | | | | LLAZ931000 | LLAZ931000 | | LOCA | LMMC | MINING CLAIM MONEY RECEIVED | 9532 | 2015 | XX |
| 3 | 7364781 | 7364780 | 3474270 | LR2KMCII | 08/28/2015 | T | 40.00 | 0.00 | 7285.00 | | | | LLAZ950000 | LLAZ931000 | | LOCA | MCTR | MAINTENANCE FEE | 18396 | 2015 | 15 |

Authorized Date 10/08/2015

Instructions to Accounts AZ BLM REFUND \$1860.00 TO GOLDENROD GROUP LLC FOR
OVERPAYMENT ON AMC366287 RECEIPT #3376036. IR

Login ID 6771

Entry Date 10/08/2015

Total Amount \$1,860.00

Re: Goldenrod Group LLC Refund (8/24/2015; Receipt 3376036; AMC366287)

Inbox x

Selbach, Rick

11:15 AM (51
minutes ago)

to me

Hi Iran,

I approved that refund back on 11/30. I just went into CBS and it looks like a check for \$1,860 was issued on 12/3.

On Mon, Dec 7, 2015 at 11:00 AM, Reyman, Iran <ireyman@blm.gov> wrote:

Hi Rick,

Can you please process the refunds for Goldenrod Group LLC and Danny Hardesty? Annabell completed step 2 back on 30 Nov. Would appreciate it very much. Thanks!

Very respectfully,

Iran Reyman

Legal Instruments Examiner
U.S. Department of the Interior
Bureau of Land Management
One N. Central Avenue, Ste 800
Phoenix, AZ 85004
Office: (602) 417-9355
Fax: (602) 417-9490/9452
ireyman@blm.gov

UNITED STATES
DEPARTMENT OF THE INTERIOR
BUREAU OF LAND MANAGEMENT
MAINTENANCE FEE PAYMENT

68526 414462
366287 416191
404917 422696
412808 423383

Remitter Name: Greg Rustin /Goldenrod LLC.

Mailing Address: P.O. Box 201

City, State, Zip: Laurel, MS 39441-0201

Check Here if Change of Address (No Change)

The maintenance fee for the following claim(s)/site(s) applies to the assessment year **2016**.

• **Placer Claims**

| <u>BLM Serial Number</u> | <u>Claim Name</u> | <u>Acreage</u> |
|--------------------------|-------------------|----------------|
| AMC366287 | GOLDEN #2 | 160 |
| AMC68554 | GOLDEN ROD | 20 |
| AMC422696 | GOLDENROD #23 | 20 |
| AMC416195 | LUKE #1 | 20 |
| AMC416196 | LUKE #2 | 20 |
| AMC416197 | LUKE #3 | 20 |
| AMC416198 | LUKE #4 | 20 |
| AMC416199 | LUKE #5 | 20 |
| AMC416200 | LUKE #6 | 20 |
| AMC416201 | LUKE #7 | 20 |
| AMC423306 423386 | LUKE #8 | 20 |
| AMC423307 423387 | LUKE #9 | 20 |
| AMC423308 423388 | LUKE #10 | 20 |
| AMC423309 423389 | LUKE #11 | 20 |
| AMC416191 | CORT #1 | 20 |
| AMC416192 | CORT #2 | 20 |
| AMC416193 | CORT #3 | 20 |
| AMC416194 | CORT #4 | 20 |
| AMC423313 423383 | CORT #5 | 20 |
| AMC423304 423384 | CORT #6 | 20 |

Wrong #
used
LEAD AMC
42328

Total placer acreage = 540
Subtotal Placer Fee Due = \$ 4,185 ✓

20 claims

RECEIVED
BLM - PHOENIX
2015 AUG 24 P 3:32
PHOENIX, ARIZONA

Refund total of \$1860

- overpayment of \$1085 -
only 25 claims listed on
2nd page not 32 as indicated

- 5 claims paid through print portal
Amc 423385 - 423389
\$775 Receipt # 3382745
AT

ENTERED
AUG 28 2015
BY: JR

RECEIPT # 3376036

NOTIFIED OF INCORRECT AMC #'S
BY MAIL. 06 OCT 15 JR

• Lode Claims

| | |
|----------------------|---------------|
| AMC404920 | GOLDENROD #7 |
| AMC404921 | GOLDENROD #8 |
| AMC404922 | GOLDENROD #9 |
| AMC404923 | GOLDENROD #10 |
| AMC412808 | GOLDENROD #18 |
| AMC412809 | GOLDENROD #17 |
| AMC412810 | GOLDENROD #16 |
| AMC412811 | GOLDENROD #15 |
| AMC412812 | GOLDENROD #14 |
| AMC412813 | GOLDENROD #13 |
| AMC412814 | GOLDENROD #12 |
| AMC412815 | GOLDENROD #11 |
| AMC414462 | GOLDENROD #19 |
| AMC414463 | GOLDENROD #20 |
| AMC414464 | GOLDENROD #21 |
| AMC414465 | GOLDENROD #22 |
| AMC416202 | SCARLET #1 |
| AMC416203 | SCARLET #2 |
| AMC416204 | SCARLET #3 |
| AMC416205 | SCARLET #4 |
| AMC416206 | SCARLET #5 |
| AMC416207 | SCARLET #6 |
| AMC416208 | SCARLET #7 |
| AMC416209 | SCARLET #8 |
| AMC423305 | CORT #7 |

~~wrong #~~ - AMC423305 423385

25 claims
3875

Total Lode Claims = 32 x \$155
Subtotal Lode Fee Due = \$4,960

Total Due = \$9,145.00

PHOENIX, ARIZONA
2015 AUG 24 P 3:32
RECEIVED

United States Department of the Interior
Bureau of Land Management
LANDS/RECREATION & PLANNING
ONE N CENTRAL AVE
PHOENIX, AZ 85004 -2203
Phone: 602-417-9200

Receipt

No: 3376036

| | |
|--|--|
| Transaction #: 3474270 | |
| Date of Transaction: 08/25/2015 | |
| CUSTOMER: | |
| GOLDENROD GROUP LLC 562 EASTVIEW DR LAUREL, MS 39443-5332 US | |

| LINE # | QTY | DESCRIPTION | REMARKS | UNIT PRICE | TOTAL |
|---------------|------|---|--|------------|-------------------|
| 1 | 1.00 | LOCATABLE MINERALS / MINING CLAIMS-NOT NEW-UNADJUD, ONE AUTH NO. ONLY / MINING CLAIM MONEY RECEIVED CASES: AMC366287/\$9145.00 | MAINT FEE PYMNT - 32 45 2016 | - n/a - | 9145.00 |
| TOTAL: | | | | | \$9,145.00 |

*\$1860.00
REFUNDED
ON 5/27/15
LB*

| PAYMENT INFORMATION | | | | |
|---------------------|-----------|---|-------------|------------|
| 1 | AMOUNT: | 9145.00 | POSTMARKED: | 08/19/2015 |
| | TYPE: | CHECK | RECEIVED: | 08/24/2015 |
| | CHECK NO: | 1048 | | |
| | NAME: | GOLDENROD GROUP LLC 562 EASTVIEW DR LAUREL MS 39443-5332 US | | |

| REMARKS |
|---------|
| |

This receipt was generated by the automated BLM Collections and Billing System and is a paper representation of a portion of the official electronic record contained therein.

ENTERED
AUG 28 2015
BY: *JP*

United States Department of the Interior
Bureau of Land Management
 BUSINESS & SUPPORT SVCS DIV
 ONE N CENTRAL AVE SUITE 800
 PHOENIX, AZ 85004 -4427
 Phone: (602) 417-9200

Receipt

No: 3382745

| | |
|--|--|
| Transaction #: 3481059 | |
| Date of Transaction: 08/31/2015 | |
| CUSTOMER: | |
| PAUL CLARK P.O. BOX 1308 CONGRESS, AZ 85332 US | |

| LINE # | QTY | DESCRIPTION | REMARKS | UNIT PRICE | TOTAL |
|---------------|------|---|---------|------------|-----------------|
| 1 | 1.00 | LOCATABLE MINERALS / MINING CLAIMS- NOT NEW-UNADJUD, ONE AUTH NO. ONLY / MINING CLAIM MONEY RECEIVED CASES: AMC423385/\$775.00 | | - n/a - | 775.00 |
| TOTAL: | | | | | \$775.00 |

| PAYMENT INFORMATION | | | | | |
|---|---------------|---|-------------|------------|--|
| NOTE: Items will appear on credit card statement as "BLM O Mining Claim". | | | | | |
| 1 | AMOUNT: | 775.00 | POSTMARKED: | N/A | |
| | TYPE: | CREDIT CARD | RECEIVED: | 08/31/2015 | |
| | NAME: | PAUL CLARK P.O. BOX 1308 CONGRESS AZ 85332 US | | | |
| | CARD NO: | XXXXXXXXXXXX8034 | AUTH CODE: | 445177 | |
| | NAME ON CARD: | PAUL CLARK | | | |
| | EXPIRES: | 10/2017 | | | |
| | SIGNATURE: | | | | |

| |
|---------|
| REMARKS |
| |

This receipt was generated by the automated BLM Collections and Billing System and is a paper representation of a portion of the official electronic record contained therein.

Authorized Date 10/05/2015

Instructions to Accounts AZ BLM REFUND \$1860.00 TO GOLDENROD GROUP LLC FOR
OVERPAYMENT ON AMC366287 RECEIPT #3376036. IR

Login ID 6771

Entry Date 10/05/2015

Total Amount \$1,860.00

**DEPARTMENT OF THE INTERIOR
BUREAU OF LAND MANAGEMENT
MINING CLAIMS**

**MC Customer Information - With Serial No. and Last Assessment Code
ACTIVE, CLOSED CLAIMS**

Admin State: AZ
Geo State: AZ

**CLARK PAUL
PO BOX 1308
CONGRESS, AZ 85332-1308**

CUSTOMER ID: 2240537

| <u>Serial No.</u> | <u>Claim Name/Number</u> | <u>Last Assmt Code</u> | <u>Last Assmt YR</u> | <u>Disposition</u> |
|-------------------|--------------------------|------------------------|----------------------|--------------------|
| AMC352160 | MUSTANG | 782 | 2016 | ACTIVE |
| AMC373840 | LITTLE PICKER | 782 | 2016 | ACTIVE |
| AMC373843 | OLY POP | 782 | 2016 | ACTIVE |
| AMC373844 | SARAH P | 782 | 2016 | ACTIVE |
| AMC375662 | YAMAHA 1 | 782 | 2016 | ACTIVE |
| AMC375663 | YAMAHA 2 | 782 | 2016 | ACTIVE |
| AMC414571 | MUSTANG #1 | 782 | 2016 | ACTIVE |

Number of ACTIVE cases: 7

| | | | | |
|-----------|------------------|-----|------|--------|
| AMC353534 | P & R #1 | 482 | 2002 | CLOSED |
| AMC353535 | P & R #2 | 482 | 2002 | CLOSED |
| AMC412452 | MUSTANG #3 | 484 | 2012 | CLOSED |
| AMC413296 | MUSTANG #4 | 484 | 2012 | CLOSED |
| AMC414572 | MUSTANG #2 | 484 | 2012 | CLOSED |
| AMC414573 | MUSTANG #5 | 484 | 2012 | CLOSED |
| AMC415621 | CONGRESS GOLD #1 | 682 | 2013 | CLOSED |
| AMC415622 | CONGRESS GOLD #2 | 682 | 2013 | CLOSED |
| AMC415623 | CONGRESS GOLD #3 | 682 | 2013 | CLOSED |
| AMC415624 | CONGRESS GOLD #4 | 682 | 2013 | CLOSED |
| AMC415625 | CONGRESS GOLD #5 | 682 | 2013 | CLOSED |
| AMC415626 | CONGRESS GOLD #6 | 682 | 2013 | CLOSED |

Number of CLOSED cases: 12

**CLARK PAUL C
BOX 562
NEEDLES, CA 92363**

CUSTOMER ID: 14477

| <u>Serial No.</u> | <u>Claim Name/Number</u> | <u>Last Assmt Code</u> | <u>Last Assmt YR</u> | <u>Disposition</u> |
|-------------------|--------------------------|------------------------|----------------------|--------------------|
| AMC306367 | CLARK MINING CO #1 | 000 | 0000 | CLOSED |

Number of CLOSED cases: 1

GOLDEN ROD GROUP LLC
562 EASTVIEW DR
LAUREL, MS 39443-5332

FACTORY ADDRESS, FOLD AT DOTTED LINE
CERTIFIED MAIL



1000



85004

U.S. POSTAGE
PAID
LAUREL, MS
39440
AUG 19, 15
AMOUNT
\$6.74
00132149-06

7015 0640 0002 8839 6164

BLM AZ STATE OFFICE

2015 AUG 24 P 3:14

PHOENIX, AZ

BUREAU OF LAND MANAGEMENT
ARIZONA STATE OFFICE
ONE NORTH CENTRAL AVE.
SUITE 800
PHOENIX, AZ 85004-4427

8500484427

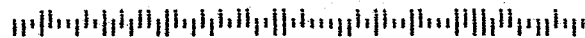

416191 366287
 421090 401294
 422696 404917
 423383 412808
 68526 414462

Maintenance Fee Payment

Claimant Name: Greg Rustin
 Address P.O. Box 201
 City Laurel State MS Zip 39941
 Telephone (601) 319-9118
 E-Mail N/A
 Signature Greg Rustin

RECEIVED
 BLM AZ STATE OFFICE
 2014 AUG 20 P 2:15
 PHOENIX, ARIZONA

Check here if this address is a change

| Line No | AMC number | Claim/Site Name | County Recorder Data (if available) | TWP | RNG | SEC |
|---------|------------|-----------------|-------------------------------------|-----|-----|---------|
| 1. | 416195 | Luke # 1 | Placer 20 Acres | 9N | 4W | 36 |
| 2. | 416196 | Luke # 2 | Placer 20 Acres | 9N | 4W | 35 & 36 |
| 3. | 416197 | Luke # 3 | Placer 20 Acres | 9N | 4W | 35 |
| 4. | 416198 | Luke # 4 | Placer 20 Acres | 9N | 4W | 35 |
| 5. | 416199 | Luke # 5 | Placer 20 Acres | 8N | 4W | 2 |
| 6. | 416200 | Luke # 6 | Placer 20 Acres | 8N | 4W | 2 |
| 7. | 416201 | Luke # 7 | Placer 20 Acres | 8N | 4W | 2 & 3 |
| 8. | 423306 | Luke # 8 | Placer 20 Acres | 9N | 4W | 36 |
| 9. | 423307 | Luke # 9 | Placer 20 Acres | 9N | 4W | 35 & 36 |
| 10. | 423308 | Luke # 10 | Placer 20 Acres | 9N | 4W | 35 |
| 11. | 423309 | Luke # 11 | Placer 20 Acres | 9N | 4W | 35 |
| 12. | 416202 | Scarlet #1 | Lode 20 Acres | 9N | 4W | 36 |
| 13. | 416203 | Scarlet # 2 | Lode 20 Acres | 9N | 4W | 36 |
| 14. | 416204 | Scarlet # 3 | Lode 20 Acres | 9N | 4W | 36 |
| 15. | 416205 | Scarlet # 4 | Lode 20 Acres | 9N | 4W | 36 |
| 16. | 416206 | Scarlet # 5 | Lode 20 Acres | 9N | 4W | 36 |
| 17. | 416207 | Scarlet # 6 | Lode 20 Acres | 9N | 4W | 36 |
| 18. | 416208 | Scarlet # 7 | Lode 20 Acres | 9N | 4W | 36 |
| 19. | 416209 | Scarlet # 8 | Lode 20 Acres | 9N | 4W | 36 |
| 20. | 416191 | Cort # 1 | Placer 20 Acres | 9N | 4W | 36 |
| 21. | 416192 | Cort # 2 | Placer 20 Acres | 9N | 4W | 35 & 36 |

423387
423388

List additional claims on Form MCF114

Bureau of Land Management
 Arizona State Office
www.blm.gov/az/

ENTERED
 AUG 20 2014
 BY: *[Signature]*

No. of Claims: 21 X \$155.00 = \$3255.00
 Check No: 1038 Init. *[Signature]*
 Receipt No: 3107967
 For BLM Use Only

Maintenance Fee Payment

Claimant Name: Greg Rustin
 Address P.O. Box 201
 City Laurel State MS Zip 39941
 Telephone (601) 319-9118
 E-Mail N/A
 Signature Greg Rustin

RECEIVED OFFICE
 BLM AZ STATE OFFICE
 2011 AUG 20 P 2:19
 PHOENIX, ARIZONA

Check here if this address is a change

| Line No | AMC number | Claim/Site Name | County Recorder Data (if available) | TWP | RNG | SEC |
|---------|------------|-----------------|-------------------------------------|-----|-----|---------|
| 1. | 416193 | Cort # 3 | Placer 20 acres | 9N | 4W | 35 |
| 2. | 416194 | Cort # 4 | Placer 20 acres | 9N | 4W | 36 |
| 3. | 423313 | Cort # 5 | Placer 20 acres | 9N | 4W | 36 |
| 4. | 423304 | Cort # 6 | Placer 20 acres | 9N | 4W | 35 & 36 |
| 5. | 423305 | Cort # 7 | Lode 20 acres | 9N | 4W | 35 |
| 6. | | | | | | |
| 7. | | | | | | |
| 8. | | | | | | |
| 9. | | | | | | |
| 10. | | | | | | |
| 11. | | | | | | |
| 12. | | | | | | |
| 13. | | | | | | |
| 14. | | | | | | |
| 15. | | | | | | |
| 16. | | | | | | |
| 17. | | | | | | |
| 18. | | | | | | |
| 19. | | | | | | |
| 20. | | | | | | |

List additional claims on Form MCF114

Bureau of Land Management
 Arizona State Office
www.blm.gov/az/

| | |
|----------------------------|-------------------------------|
| No. of Claims: <u>5</u> | X \$155.00 = \$ <u>775.00</u> |
| Check No: <u>1038</u> | Init. <u>ARJ/c</u> |
| Receipt No: <u>3107967</u> | |
| For BLM Use Only | |

Claimant Name: Greg Rustin
 Address P. O. Box 201
 City Laurel State: MS Zip 39941
 Telephone (601) 319-9118
 E-Mail N/A
 Signature *Greg Rustin*

Check here if this address is a change

| Line No | AMC number | Claim/Site Name | County Recorder Data (if available) | TWP | RNG | SEC |
|---------|-------------------------|-----------------|-------------------------------------|-----|-----|-----|
| 1. | 68554 366287 | Golden Rod # 1 | Placer 20 acres | 9N | 4W | 7 |
| 2. | 366287 | Golden Rod # 2 | Placer 160 acres | 9N | 4W | 7 |
| 3. | 401294 | Golden Rod #3 | Lode 20 acres | 9N | 4W | 7 |
| 4. | 404917 | Golden Rod # 4 | Lode 20 acres | 9N | 4W | 7 |
| 5. | 404918 | Golden Rod # 5 | Lode 20 acres | 9N | 4W | 7 |
| 6. | 404919 | Golden Rod # 6 | Lode 20 acres | 9N | 4W | 7 |
| 7. | 404920 | Golden Rod # 7 | Lode 20 | 9N | 4W | 7 |
| 8. | 404921 | Golden Rod # 8 | Lode 20 acres | 9N | 4W | 7 |
| 9. | 404922 | Golden Rod # 9 | Lode 20 acres | 9N | 4W | 7 |
| 10. | 404923 | Golden Rod # 10 | Lode 20 acres | 9N | 4W | 7 |
| 11. | 412815 | Golden Rod # 11 | Lode 20 acres | 9N | 4W | 8 |
| 12. | 412814 | Golden Rod # 12 | Lode 20 acres | 9N | 4W | 8 |
| 13. | 412813 | Golden Rod # 13 | Lode 20 acres | 9N | 4W | 8 |
| 14. | 412812 | Golden Rod # 14 | Lode 20 acres | 9N | 4W | 8 |
| 15. | 412811 | Golden Rod # 15 | Lode 20 acres | 9N | 4W | 8 |
| 16. | 412810 | Golden Rod # 16 | Lode 20 acres | 9N | 4W | 8 |
| 17. | 412809 | Golden Rod # 17 | Lode 20 acres | 9N | 4W | 8 |
| 18. | 412808 | Golden Rod # 18 | Lode 20 acres | 9N | 4W | 8 |
| 19. | 414462 | Golden Rod # 19 | Lode 20 acres | 9N | 4W | 8 |
| 20. | 414463 | Golden Rod # 20 | Lode 20 acres | 9N | 4W | 8 |
| | | | | | | |

List additional claims on Form MCF114

Bureau of Land Management
 Arizona State Office
www.blm.gov/az/

| | | |
|---------------------|-----------------|-----------|
| No. of Claims: 27 | X \$155 = | \$4185.00 |
| Check No: 1038 | Init. <i>GR</i> | |
| Receipt No: 3102967 | | |
| For BLM Use Only | | |

Maintenance Fee Payment

Claimant Name: Greg Rustin
 Address P. O. Box 201
 City Laurel State MS Zip 39941
 Telephone (601) 319-9118
 E-Mail N/A
 Signature Greg Rustin

RECEIVED
 BLM AZ STATE OFFICE
 2014 AUG 20 P 2:16
 PHOENIX, ARIZONA

Check here if this address is a change

| Line No | AMC number | Claim/Site Name | County Recorder Data (if available) | TWP | RNG | SEC |
|---------|------------|-----------------|-------------------------------------|-----|-----|-------|
| 1. | 414464 | Golden Rod # 21 | Lode 20 acres | 9N | 4W | 8 |
| 2. | 414465 | Golden Rod # 22 | Lode 20 acres | 9N | 4W | 5 & 8 |
| 3. | 422696 | Golden Rod # 23 | Placer 20 acres | 9N | 4W | 6 |
| 4. | 422697 | Golden Rod # 24 | Lode 20 acres | 9N | 4W | 6 |
| 5. | 422698 | Golden Rod # 25 | Lode 20 acres | 9N | 4W | 6 |
| 6. | 421111 | Rideco No. 8 | Lode under 3 acre | 9N | 4W | 6 |
| 7. | | | | | | |
| 8. | | | | | | |
| 9. | | | | | | |
| 10. | | | | | | |
| 11. | | | | | | |
| 12. | | | | | | |
| 13. | | | | | | |
| 14. | | | | | | |
| 15. | | | | | | |
| 16. | | | | | | |
| 17. | | | | | | |
| 18. | | | | | | |
| 19. | | | | | | |
| 20. | | | | | | |

List additional claims on Form MCF114

Bureau of Land Management
 Arizona State Office
www.blm.gov/az/

| | | |
|----------------------------|------------------|------------------|
| No. of Claims: <u>6</u> | X \$155 = | \$ <u>930.00</u> |
| Check No: <u>1038</u> | Init. <u>ASA</u> | |
| Receipt No: <u>3107967</u> | | |
| For BLM Use Only | | |

| Page | # Claims | Amount |
|--------------------|------------------|------------------|
| # 1 | 21 Claims | \$ 3255.00 |
| # 2 | 5 Claims | \$ 775.00 |
| # 3 | 27 Claims | \$ 4185.00 |
| # 4 | 6 Claims | \$ 930.00 |
| Grand Total | 59 Claims | \$9145.00 |

RECEIVED
BLM AZ STATE OFFICE
2014 AUG 20 P 2: 16
PHOENIX, ARIZONA

United States Department of the Interior
Bureau of Land Management
LANDS/RECREATION & PLANNING
ONE N CENTRAL AVE
PHOENIX, AZ 85004 -2203
Phone: 602-417-9200

Receipt

No: 3107967

| | |
|---|--|
| Transaction #: 3199624 | |
| Date of Transaction: 08/21/2014 | |
| CUSTOMER: | |
| GREGORY RUSTIN PO BOX 201 LAUREL,MS 39441-0201 US | |

| LINE # | QTY | DESCRIPTION | REMARKS | UNIT PRICE | TOTAL |
|---------------|------|--|---------------------------|------------|-------------------|
| 1 | 1.00 | LOCATABLE MINERALS / MINING CLAIMS-NOT NEW-UNADJUD,ONE AUTH NO. ONLY / MINING CLAIM MONEY RECEIVED CASES: AMC416195/\$9145.00 | MAINT FEE PYMNT (59) 2015 | - n/a - | 9145.00 |
| TOTAL: | | | | | \$9,145.00 |

| PAYMENT INFORMATION | | | | | |
|---------------------|-----------|--|-------------|------------|--|
| 1 | AMOUNT: | 9145.00 | POSTMARKED: | 08/15/2014 | |
| | TYPE: | CHECK | RECEIVED: | 08/20/2014 | |
| | CHECK NO: | 1038 | | | |
| | NAME: | GOLDENROD GROUP LLC 562 EASTVIEW DR LAUREL MS 39443 US | | | |

| |
|---------|
| REMARKS |
| |

This receipt was generated by the automated BLM Collections and Billing System and is a paper representation of a portion of the official electronic record contained therein.

Authorized Date 02/25/2014

Instructions to Accounts AZ BLM REFUND \$140 TO GREGORY RUSTIN FOR DUPLICATE 2013 MAINTENANCE FEES PAID ON AMC68554. RECEIPT#2648035. RE.

Login ID 4105

Entry Date 02/25/2014

Total Amount \$140.00

Verified address (for refund)
by phone call with
Greg Rustin

R Ebert 2-25-14

Tony

*#140
CX*

**United States Department of the Interior
Bureau of Land Management
LANDS/RECREATION & PLANNING
ONE N CENTRAL AVE
PHOENIX, AZ 85004 -2203
Phone: 602-417-9200**

Receipt

No: 2648035

| | |
|--|--|
| Transaction #: 2728817 | |
| Date of Transaction: 09/04/2012 | |
| CUSTOMER: | |
| GREGORY RUSTIN 562 EASTVIEW DR LAUREL,MS 39443-5332 US | |

| LINE # | QTY | DESCRIPTION | REMARKS | UNIT PRICE | TOTAL |
|---------------|------|---|------------------|------------|-------------------|
| 1 | 1.00 | LOCATABLE MINERALS / MINING CLAIMS- NOT NEW-UNADJUD,ONE AUTH NO. ONLY / MINING CLAIM MONEY RECEIVED CASES: AMC366287/\$4060.00 | MAINT 2013/22 | - n/a - | 4060.00 |
| TOTAL: | | | | | \$4,060.00 |

| PAYMENT INFORMATION | | | |
|---------------------|-----------|---|----------------------|
| 1 | AMOUNT: | 4060.00 | POSTMARKED: N/A |
| | TYPE: | CHECK | RECEIVED: 08/31/2012 |
| | CHECK NO: | 200160469 | |
| | NAME: | RUSTIN, GREGORY 562 EASTVIEW DR LAUREL MS 39443-5332 US | |

| |
|---------|
| REMARKS |
| |

This receipt was generated by the automated BLM Collections and Billing System and is a paper representation of a portion of the official electronic record contained therein.

~~*P.O. Box 201*~~

*\$140 refund authorized for
duplicate 2013 maintenance fee
on AMC 68554.*

RE 2-25-12

RUSTIN METAL BUILDINGS AND CONSTRUCTION

LICENED GENERAL CONTRACTOR-COR#17343-MC

P.O. BOX 63, LAUREL, MS 39441

PHONE 601-649-9949 CELL 601-319-9118

68526
366287
422696
401294
404917
412808
414462

To: BLM

Mr. Gregory D. Rustin owner of Golden Rod Group LLC is requesting an address change. Please make this change on all Golden Rod Group LLC documents.

From: Golden Rod Group LLC
562 Eastview Dr
Laurel, MS 39443

To: Golden Rod Group LLC
P.O.Box 201
Laurel, MS 39441

Thank You
Gregory D Rustin

GOLDENROD GROUP LLC

562 EASTVIEW DRIVE

Laurel, MS 39443-5332

Phone 601-319-9118

Amc 68526
Amc 366287
Amc 422696
Amc 401294
Amc 404917
Amc 412808
Amc 414462

July 9, 2013

Bureau of Land Management
Arizona State Office
One North Central Avenue
Suite 800
Phoenix, AZ 85004-4427
Phone:(602) 417-9200

Re: 2014 Maintanece Fee Payment

Gentlemen:

Enclosed you will find payment for our 2014 maintenance requirements of \$ 4,620 for our placer and lode mining claims. If you have any questions you may call myself or Michael Snyder 760-401-0530 if there is any issue whatsoever with this remittance.

Thank you for your prompt attention to this matter.

Sincerely,

Greg Rustin
Goldenrod Group LLC.

NO. OF CLAIMS 26
AMOUNT \$4620.⁰⁰
RECEIPT NO. 28705876
INIT. [Signature]
** BLM-ASO**

ENTERED
Aug 29 2013
BY: TS

RECEIVED
BLM AZ STATE OFFICE
2013 AUG 26 P 1:16
PHOENIX, ARIZONA

UNITED STATES
DEPARTMENT OF THE INTERIOR
BUREAU OF LAND MANAGEMENT
MAINTENANCE FEE PAYMENT

RECEIVED
 BLM AZ STATE OFFICE
 2013 AUG 26 P 1:16
 PHOENIX, ARIZONA

Remitter Name: Greg Rustin /Goldenrod LLC.

Mailing Address: 562 Eastview Drive

City, State, Zip: Laurel, MS 39443-5332

XXX Check Here if Change of Address
 (please change address on AMC 366287 and AMC 68526)
not owners - on address change

The maintenance fee for the following claim(s)/site(s) applies to the assessment year **2014**.

• **Placer Claims**

| <u>BLM Serial Number</u> | <u>Claim Name</u> |
|--------------------------|-------------------|
| AMC366287 _____ | GOLDEN #2 |
| AMC68554 _____ | GOLDEN ROD |
| AMC422696 _____ | GOLDENROD #23 |

Total placer acreage = 200
 Subtotal Placer Fee Due = \$1,400

• **Lode Claims**

| <u>BLM Serial Number</u> | <u>Claim Name</u> |
|--------------------------|-------------------|
| AMC421111 _____ | RIDECO NO. 8 |
| AMC422697 _____ | GOLDENROD #24 |
| AMC422698 _____ | GOLDENROD #25 |
| AMC401294 _____ | GOLDEN ROD #3 |
| AMC404917 _____ | GOLDENROD #4 |
| AMC404918 _____ | GOLDENROD #5 |
| AMC404919 _____ | GOLDENROD #6 |
| AMC404920 _____ | GOLDENROD #7 |
| AMC404921 _____ | GOLDENROD #8 |
| AMC404922 _____ | GOLDENROD #9 |
| AMC404923 _____ | GOLDENROD #10 |
| AMC412808 _____ | GOLDENROD #18 |
| AMC412809 _____ | GOLDENROD #17 |
| AMC412810 _____ | GOLDENROD #16 |
| AMC412811 _____ | GOLDENROD #15 |
| AMC412812 _____ | GOLDENROD #14 |
| AMC412813 _____ | GOLDENROD #13 |
| AMC412814 _____ | GOLDENROD #12 |
| AMC412815 _____ | GOLDENROD #11 |
| AMC414462 _____ | GOLDENROD #19 |
| AMC414463 _____ | GOLDENROD #20 |
| AMC414464 _____ | GOLDENROD #21 |
| AMC414465 _____ | GOLDENROD #22 |

Total Lode Claims = 23 x \$140
 Subtotal Lode Fee Due = \$3,220

| |
|-----------------------------------|
| <p>Total Due = \$4,620</p> |
|-----------------------------------|

United States Department of the Interior
Bureau of Land Management
 LANDS/RECREATION & PLANNING
 ONE N CENTRAL AVE
 PHOENIX, AZ 85004 -2203
 Phone: 602-417-9200

Receipt

No: 2865816

| | |
|---|--|
| Transaction #: 2951737 | |
| Date of Transaction: 08/27/2013 | |
| CUSTOMER: | |
| GOLDENROD GROUP LLC 562 EASTVIEW DR LAUREL,MS 39443-5332 US | |

| LINE # | QTY | DESCRIPTION | REMARKS | UNIT PRICE | TOTAL |
|---------------|------|--|---------------------------|------------|-------------------|
| 1 | 1.00 | LOCATABLE MINERALS / MINING CLAIMS-NOT NEW-UNADJUD,ONE AUTH NO. ONLY / MINING CLAIM MONEY RECEIVED CASES: AMC366287/\$4620.00 | MAINT FEE PYMNT (26) 2014 | - n/a - | 4620.00 |
| TOTAL: | | | | | \$4,620.00 |

| PAYMENT INFORMATION | | | |
|---------------------|-----------|---|------------------------|
| 1 | AMOUNT: | 4620.00 | POSTMARKED: 08/22/2013 |
| | TYPE: | CHECK | RECEIVED: 08/26/2013 |
| | CHECK NO: | 1024 | |
| | NAME: | GOLDENROD GROUP LLC 562 EASTVIEW DR LAUREL MS 39443-5332 US | |

| |
|---------|
| REMARKS |
| |

This receipt was generated by the automated BLM Collections and Billing System and is a paper representation of a portion of the official electronic record contained therein.

Amc 366287

401294

Authorized Date 10/16/2012

404917

AZ BLM REFUND \$140 TO GREGORY RUSTIN FOR

Instructions to Accounts DUPLICATE MAINTENANCE FEE S PAID ON AMC68554.

412808

RECEIPT#2648035. RE.

Login ID 4105

414462

Entry Date 10/16/2012

Total Amount \$140.00

Rustin, Greg
562 Eastview Drive
LAUREL, MS 39443-5332

Amc 366287
401294
404917
412808
414462

| <u>Serial No.</u> | <u>Claim Name/</u> |
|-------------------|--------------------|
| AMC401294 | GOLDEN ROD #3 |
| AMC404917 | GOLDENROD #4 |
| AMC404918 | GOLDENROD #5 |
| AMC404919 | GOLDENROD #6 |
| AMC404920 | GOLDENROD #7 |
| AMC404921 | GOLDENROD #8 |
| AMC404922 | GOLDENROD #9 |
| AMC404923 | GOLDENROD #10 |
| AMC412808 | GOLDENROD #18 |
| AMC412809 | GOLDENROD #17 |
| AMC412810 | GOLDENROD #16 |
| AMC412811 | GOLDENROD #15 |
| AMC412812 | GOLDENROD #14 |
| AMC412813 | GOLDENROD #13 |
| AMC412814 | GOLDENROD #12 |
| AMC412815 | GOLDENROD #11 |
| AMC414462 | GOLDENROD #19 |
| AMC414463 | GOLDENROD #20 |
| AMC414464 | GOLDENROD #21 |
| AMC414465 | GOLDENROD #22 |

These are the Lodes
\$140 x 20 Claims = \$2,800



Number of ACTIVE cases: 20

RECEIVED
BLM AZ STATE OFFICE
2012 AUG 31 P 2:26
PHOENIX, ARIZONA

Rustin, Gregory D
~~PO Box 4031~~ 562 Eastview Dr
LAUREL, MS 39443-~~4031~~
3

This is the Association
160 acre placer claim.

AMC366287 GOLDEN #2

This is the one the fees
increased on. So it is
\$1,120 (permit is on this
one also)

Number of ACTIVE cases: 1

GOLDEN ROD GROUP LLC
~~PO Box 4081~~ 562 Eastview Dr
LAUREL, MS 39443-~~4081~~
3

\$140 refund authorized for
duplicate maint. fee for #
AMC 68554 RE 10-16-12

AMC 68554 GOLDEN ROD

This is the 1930's original
20 acre placer claim
\$140 due this year.

Number of ACTIVE cases: 1

Total of 22 claims. \$4060 due
to BLM. 580 acres of claims

ENTERED INTO COMPUTER
9/11/2012
TS

Refund \$140 for 68554
paid last yr

MAINTENANCE FEE PAYMENT

Claimant Name: Greg Rustin
 Address: 562 Eastview Drive
 City: Lavee State: MS Zip: 39443
 Telephone: 601 319 9118
 E-mail address: _____
 Signature: Greg Rustin

Check here if this is a change of address.

RECEIVED
 BLM AZ STATE OFFICE
 PHOENIX, ARIZONA
 2012 AUG 31 P 2 20
 BLM Date Stamp

| LINE NO. | AMC NUMBER | CLAIM/SITE NAME | COUNTY RECORDER DATA (if available) | TWP | RNG | SEC |
|----------|------------|-----------------|-------------------------------------|-----|-----|-----|
| 1 | 366287 | Golden Rod #2 | place \$1120 | 9N | 4W | 7NE |
| 2 | 68554 | Golden Rod #1 | place 140 | 9N | 4W | 7NE |
| 3 | 401294 | Golden Rod #3 | Lode 140 | 9N | 4W | 7NE |
| 4 | 404917 | Golden Rod #4 | Lode 140 | 9N | 4W | 7NE |
| 5 | 404918 | Golden Rod #5 | Lode 140 | 9N | 4W | 7NE |
| 6 | 404919 | Golden Rod #6 | Lode 140 | 9N | 4W | 7NE |
| 7 | 404920 | Golden Rod #7 | Lode 140 | 9N | 4W | 7NE |
| 8 | 404921 | Golden Rod #8 | Lode 140 | 9N | 4W | 7NE |
| 9 | 404922 | Golden Rod #9 | Lode 140 | 9N | 4W | 7NE |
| 10 | 404923 | Golden Rod #10 | Lode 140 | 9N | 4W | 7NE |

List additional claims on Form MCF114.

Bureau of Land Management
 Arizona State Office
 www.blm.gov/az/

No. of Claims: 22 x \$140 = \$4,060
 Check No: 2001604119
 Receipt No.: 2648035
 For BLM Use Only

Form: MCF112
 Revised July 2009

This form is available from the Arizona Department of Mines and Mineral Resources and may be reproduced.

#2

MAINTENANCE FEE PAYMENT

Claimant Name: Greg Rustin
 Address: 562 East View Drive
 City: Laurel State: MS Zip: 39443
 Telephone: 601 319 9118
 E-mail address: _____
 Signature: Greg Rustin

Check here if this is a change of address.

RECEIVED
BLM AZ STATE OFFICE
2012 AUG 31 P 2:28
PHOENIX, ARIZONA
BLM
Date
Stamp

| LINE NO. | AMC NUMBER | CLAIM/SITE NAME | COUNTY RECORDER DATA (if available) | TWP | RNG | SEC |
|----------|------------|-----------------|-------------------------------------|-----|-----|-----|
| 1 | 412815 | Golden Rod #11 | Lode 140 | 9N | 4W | 8 |
| 2 | 412814 | Golden Rod #12 | Lode 140 | 9N | 4W | 8 |
| 3 | 412813 | Golden Rod #13 | Lode 140 | 9N | 4W | 8 |
| 4 | 412812 | Golden Rod #14 | Lode 140 | 9N | 4W | 8 |
| 5 | 412811 | Golden Rod #15 | Lode 140 | 9N | 4W | 8 |
| 6 | 412810 | Golden Rod #16 | Lode 140 | 9N | 4W | 8 |
| 7 | 412809 | Golden Rod #17 | Lode 140 | 9N | 4W | 8 |
| 8 | 412808 | Golden Rod #18 | Lode 140 | 9N | 4W | 8 |
| 9 | | | | | | |
| 10 | | | | | | |

List additional claims on Form MCF114.

Bureau of Land Management
 Arizona State Office
 www.blm.gov/az/

No. of Claims: 8 x \$140 = \$1120⁰⁰
 Check No: _____ Init. _____
 Receipt No.: _____
 For BLM Use Only

Form: MCF112
 Revised July 2009

This form is available from the Arizona Department of Mines and Mineral Resources and may be reproduced.

3

MAINTENANCE FEE PAYMENT

Claimant Name: Greg Rustin
 Address: 562 Eastview Dr
 City: Lanett State: ms Zip: 39443
 Telephone: 601 3199118
 E-mail address: _____
 Signature: Greg Rustin

Check here if this is a change of address.

RECEIVED
BLM AZ STATE OFFICE
2012 AUG 31 P 2:26
PHOENIX, ARIZONA

BLM
Date
Stamp

| LINE NO. | AMC NUMBER | CLAIM/SITE NAME | COUNTY RECORDER DATA (If available) | TWP | RNG | SEC |
|----------|------------|-----------------|-------------------------------------|-----|-----|-----|
| 1 | 414462 | | | 9N | 4W | 8 |
| 2 | 414463 | | | 9N | 4W | 8 |
| 3 | 414464 | | | 9N | 4W | 8 |
| 4 | 414465 | | | 9N | 4W | 8 |
| 5 | | | | | | |
| 6 | | | | | | |
| 7 | | | | | | |
| 8 | | | | | | |
| 9 | | | | | | |
| 10 | | | | | | |

List additional claims on Form MCF114.

Bureau of Land Management
 Arizona State Office
www.blm.gov/az/

No. of Claims: 4 x \$140 = 560
 Check No: _____ Init: _____
 Receipt No.: _____
 For BLM Use Only

Form: MCF112
 Revised July 2009

View/Print Label

1. **Print the label:** Select Print from the File menu in this browser window to print the label below.
2. **Fold the printed label at the dotted line.** Place the label in a UPS Shipping Pouch. If you do not have a pouch, affix the folded label using clear plastic shipping tape over the entire label.

3. GETTING YOUR SHIPMENT TO UPS



Customers without a Daily Pickup

- Take this package to any location of The UPS Store®, UPS Drop Box, UPS Customer Center, UPS Alliances (Office Depot® or Staples®) or Authorized Shipping Outlet near you or visit www.ups.com/content/us/en/index.jsx and select Drop Off.
- Air shipments (including Worldwide Express and Expedited) can be picked up or dropped off. To schedule a pickup, or to find a drop-off location, select the Pickup or Drop-off icon from the UPS tool bar.

Customers with a Daily Pickup

- Your driver will pickup your shipment(s) as usual.

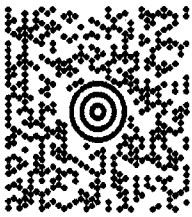
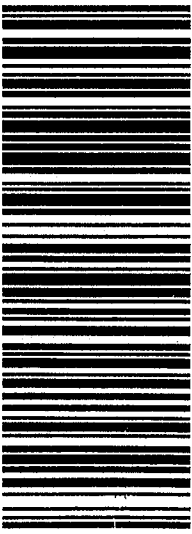
FOLD HERE

| | | | |
|---|--|--|---|
| <p>1 OF 1</p> <p>RUSTIN METAL BLDGS AND CONSTRU 1 LBS 6016499949 318 EAST 18TH ST LAUREL MS 39441</p> <p>DWT: 12,9,1</p> <p>SHIP TO: BUREAU OF LAND MANAGEMENT ARIZONA STATE OFFICE SUITE 800 ONE NORTH CENTRAL AVE PHOENIX AZ 85004</p> | <p>AZ 850 9-10</p>   | <p>2</p> <p>UPS 2ND DAY AIR</p> <p>TRACKING #: 1Z 86V 913 35 9790 9044</p>  | <p>BILLING: P/P SIGNATURE REQUIRED</p> <p>Reference No.1: 634818527556443750</p> <p>XOL 12.07.21 NWS0 30.0A 07/2012</p>  |
|---|--|--|---|

View/Print Label

1. **Print the label:** Select Print from the File menu in this browser window to print the label below.
2. **Fold the printed label at the dotted line.** Place the label in a UPS Shipping Pouch. If you do not have a pouch, affix the folded label using clear plastic shipping tape over the entire label.

3. GETTING YOUR SHIPMENT TO UPS





Customers without a Daily Pickup

- Take this package to any location of The UPS Store®, UPS Drop Box, UPS Customer Center, UPS Alliances (Office Depot® or Staples®) or Authorized Shipping Outlet near you or visit www.ups.com/content/us/en/index.jsx and select Drop Off.
- Air shipments (including Worldwide Express and Expedited) can be picked up or dropped off. To schedule a pickup, or to find a drop-off location, select the Pickup or Drop-off icon from the UPS tool bar.

Customers with a Daily Pickup

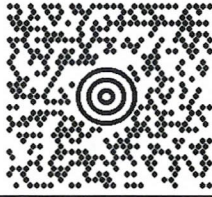
- Your driver will pickup your shipment(s) as usual.

FOLD HERE

| | | |
|--|---|--|
| RUSTIN METAL BLDGS AND CONSTRU 6016499949 318 EAST 18TH ST LAUREL MS 39441 | 1 LBS | 1 OF 1 |
| SHIP TO: BUREAU OF LAND MANAGEMENT ARIZONA STATE OFFICE SUITE 800 ONE NORTH CENTRAL AVE PHOENIX AZ 85004 | | |
|  | AZ 850 9-10  | |
| UPS 2ND DAY AIR | 2 | |
| TRACKING #: 1Z 86V 913 35 9790 9044 | | |
|  | | |
| BILLING: P/P SIGNATURE REQUIRED | | |
| Reference No.1: 634818527556443750 | |  |
| XOL 12.07.21 | NV50 30.0A 07/2012 | |

To Reuse Envelope:



1 Peel off old labels

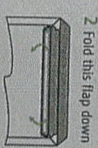

2 Fold this flap down

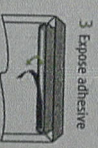

3 Expose adhesive

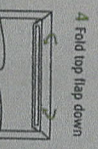

4 Fold top flap down

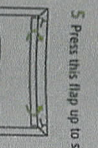

5 Press this flap up to seal

PULL TAB TO OPEN



RECEIVED
BLMAZ STATE OFFICE

2012 AUG 31 P 3:09

Call 1-800-PICK-UPS® (1-800-742-5877) or visit UPS.com®

Domestic Shipments

- To qualify for the Letter rate, UPS Express Envelopes may only contain correspondence, urgent documents, and/or electronic media, and must weigh 8 oz. or less. UPS Express Envelopes containing items other than those listed or weighing more than 8 oz. will be billed by weight.

International Shipments

- The UPS Express Envelope may be used only for documents and low commercial value. Certain countries consider electronic media documents. Visit ups.com/import to verify if your shipment is eligible as a document.

- To qualify for the Letter rate, UPS Express Envelopes weigh 10.5 oz. or less.

Note: Express Envelopes are not to be used for shipping personal or cash equivalents.

Reusable Letter Size

Reduce paper waste either by return to sender or reuse in another envelope.

Decision Green

Decision Green is UPS's commitment to our pursuit of sustainable business practices. For example, this envelope is made from 100% recycled material and is both chlorine and acid free.

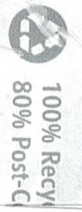

RUSTIN METAL BLDGS AND CONSTRU 1 LBS 1 OF 1
6016499949
318 EAST 18TH ST
LAUREL MS 39441
DWT: 12,9,1

SHIP TO:
BUREAU OF LAND MANAGEMENT
ARIZONA STATE OFFICE
SUITE 800
ONE NORTH CENTRAL AVE
PHOENIX AZ 85004



AZ 850 9-10



UPS 2ND DAY AIR
TRACKING #: 1Z 86V 913 35 9790 9044

2



BILLING: P/P
SIGNATURE REQUIRED

Reference No.1: 634818527556443750

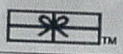

XOL 12.07.21 NV50 30.0A 07/2012

PHOENIX, ARIZONA

This envelope is for use

UPS Next Day Air®
UPS Worldwide Express®
UPS 2nd Day Air®

Do not use this envelope for:

UPS Ground
UPS Store
UPS 3 Day Select

Inside.

International Shipping Notice: This subject to the rules, including liability and other terms and/or conditions established by the Convention for the Unification of Certain Rules Relating to International Carriage by Air (the "Warsaw Convention") and/or the Convention on the Contract for the International Carriage of Goods by Road (the "CMR Convention"). These commodities, technology or software were exported from the U.S. in accordance with the Export Administration Regulations. Division contrary to U.S. law prohibited. 010195112 04/11 PAC United Parcel Service, Louisville, KY

United States Department of the Interior

Bureau of Land Management

LANDS/RECREATION & PLANNING

ONE N CENTRAL AVE

PHOENIX, AZ 85004 -2203

Phone: 602-417-9200

Receipt

No:

2648035

| | | |
|---|--|-----------------------|
| Transaction #: 2728817 | | ENTERED INTO COMPUTER |
| Date of Transaction: 09/04/2012 | | |
| CUSTOMER: | | |
| GREGORY RUSTIN 562 EASTVIEW DR LAUREL, MS 39443-5332 US | | |

| LINE # | QTY | DESCRIPTION | REMARKS | UNIT PRICE | TOTAL |
|---------------|------|---|------------------|------------|-------------------|
| 1 | 1.00 | LOCATABLE MINERALS / MINING CLAIMS-NOT NEW-UNADJUD, ONE AUTH NO. ONLY / MINING CLAIM MONEY RECEIVED CASES: AMC366287/\$4060.00 | MAINT 2013/22 | - n/a - | 4060.00 |
| TOTAL: | | | | | \$4,060.00 |

| PAYMENT INFORMATION | | | | | | |
|---------------------|-----------|---|-------------|------------|--|--|
| 1 | AMOUNT: | 4060.00 | POSTMARKED: | N/A | | |
| | TYPE: | CHECK | RECEIVED: | 08/31/2012 | | |
| | CHECK NO: | 200160469 | | | | |
| | NAME: | RUSTIN, GREGORY 562 EASTVIEW DR LAUREL MS 39443-5332 US | | | | |

| |
|---------|
| REMARKS |
| |

This receipt was generated by the automated BLM Collections and Billing System and is a paper representation of a portion of the official electronic record contained therein. NOV 27 2012

Amc

401294
404917
412808
414462
366287

lead file #'s
(PB)

\$140 refund authorized
for duplicate maint. fee
payment for AMC 68554

RE 10.16.12

AMC 366287
AMC 68526

MAINTENANCE FEE PAYMENT

Claimant Name: Gregory Rustin
Address: P.O. Box 63
City: Laurel State: MS Zip: 39441
Telephone: 601 319 9118 or 601 433 7507
E-mail address: rustinbu.kings@aol.com
Signature: Gregory Rustin

Check here if this is a change of address.

RECEIVED
BLM AZ STATE OFFICE
2011 AUG 23 A 7:54
PHOENIX, ARIZONA
BLM
Date
Stamp

2012 Fees

| LINE NO. | AMC NUMBER | CLAIM/SITE NAME | COUNTY RECORDER DATA (If available) | TWP | RNG | SEC |
|----------|------------|-----------------|-------------------------------------|-----|-----|---------|
| 1 | 366287 | Golden Rod #2 | | 9N | 4W | 7NE 1/4 |
| 2 | 68554 | | | 9N | 4W | 7NE 1/4 |
| 3 | | | | | | |
| 4 | | | | | | |
| 5 | | | | | | |
| 6 | | | | | | |
| 7 | | | | | | |
| 8 | | | | | | |
| 9 | | | | | | |
| 10 | | | | | | |

List additional claims on Form MCF114.

No. of Claims: 2 x \$140 = \$280
Check No: _____ Init. SR
Receipt No.: 2412372
For BLM Use Only

Bureau of Land Management
Arizona State Office
www.blm.gov/az/

Form: MCF112
Revised July 2009

This form is available from the Arizona Department of Mines and Mineral Resources and may be reproduced.

AUG 31 2011
cm

Gregory Rustin
P.O. Box 63
Laurel, MS 39441

BLM AZ STATE OFFICE

2011 AUG 22 P 1:00

PHOENIX, ARIZONA

PLACE STICKER AT TOP OF ENVELOPE
OF THE RETURN ADDRESS, FOLD AT DOTTED LINE

CERTIFIED MAIL™



7010 3090 0002 4009 3978



UNITED STATES
POSTAL SERVICE

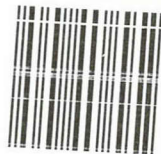

1000

85004

U.S. POSTAGE
PAID
LAUREL, MS
39440
AUG 17, 11
AMOUNT

\$5.59

00077175-10

United States Department of the Interior
Bureau of Land Management
One North Central Ave, Suite 800
Phoenix, AZ 85004-4427

850044427



Gregory Rustin
P.O. box 63
Laurel, MS 39441

DELIVERED
BLM AZ STATE OFFICE

2011 AUG 22 P 1:00

PHOENIX, ARIZONA



United States Department of the Interior
Bureau of Land Management
One North Central Ave, Suite 800
Phoenix, AZ 85004-4427

850044427

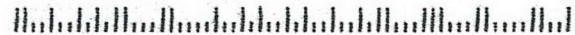

United States Department of the Interior

Bureau of Land Management
 LANDS/RECREATION & PLANNING
 ONE N CENTRAL AVE
 PHOENIX, AZ 85004 -2203
 Phone: 602-417-9200

Receipt

No:

2412372

| | |
|--|--|
| Transaction #: 2487725 | |
| Date of Transaction: 08/23/2011 | |
| CUSTOMER: | |
| GREGORY RUSTIN PO BOX 63 LAUREL,MS 39441-0063 US | |

| LINE # | QTY | DESCRIPTION | REMARKS | UNIT PRICE | TOTAL |
|---------------|------|--|---------|------------|-----------------|
| 1 | 1.00 | LOCATABLE MINERALS / MINING CLAIMS-NOT NEW-UNADJUD,ONE AUTH NO. ONLY / MINING CLAIM MONEY RECEIVED CASES: AMC366287/\$280.00 | MAINT-2 | - n/a - | 280.00 |
| TOTAL: | | | | | \$280.00 |

| PAYMENT INFORMATION | | | | | |
|---------------------|-----------|---|-------------|------------|--|
| 1 | AMOUNT: | 280.00 | POSTMARKED: | 08/17/2011 | |
| | TYPE: | CHECK | RECEIVED: | 08/23/2011 | |
| | CHECK NO: | 14-313494014 | | | |
| | NAME: | RUSTIN, GREGORY PO BOX 63 LAUREL MS 39441-0063 US | | | |

| |
|---------|
| REMARKS |
| |

This receipt was generated by the automated BLM Collections and Billing System and is a paper representation of a portion of the official electronic record contained therein.

AMC 366287

MAINTENANCE FEE PAYMENT

Claimant Name: Gregory Rustin
Address: PO Box 63
City: Laurel State: MS Zip: 39441
Telephone: 6013199118 or 6014337507
E-mail address: rustinbuildings@aol.com
Signature: Gregory Rustin

RECEIVED
BLM AZ STATE OFFICE
2010 AUG 18 A 10: 11
PHOENIX, ARIZONA
BLM
Date
Stamp

Check here if this is a change of address.

| LINE NO. | AMC NUMBER | CLAIM/SITE NAME | COUNTY RECORDER DATA (If available) | TWP | RNG | SEC |
|----------|------------|-----------------|-------------------------------------|-----|-----|--------|
| 1 | 366287 | Golden Red #2 | | 9N | 4W | 7NE1/4 |
| 2 | 68554 | Golden Red | | 9N | 4W | 7NE1/4 |
| 3 | | | | | | |
| 4 | | | | | | |
| 5 | | | | | | |
| 6 | | | | | | |
| 7 | | | | | | |
| 8 | | | | | | |
| 9 | | | | | | |
| 10 | | | | | | |

ENTERED INTO COMPUTER
AUG 25 2010

List additional claims on Form MCF114.

Bureau of Land Management
Arizona State Office
www.az.blm.gov

No. of Claims: 2 x \$¹⁴⁰~~125~~ = 280.00
Check No: 14130012206 Init. Att.
Receipt No.: 21936666
For BLM Use Only

Form: MCF112
Revised July 2005

This form is available from the Arizona Department of Mines and Mineral Resources and may be reproduced.

Talked to Mr. Rustin
on the phone 8/26/2010
He okayed earning money for
2012 Maint Fee on AMC 68554
RE

United States Department of the Interior
Bureau of Land Management
 LANDS/RECREATION & PLANNING
 ONE N CENTRAL AVE
 PHOENIX, AZ 85004 -2203
 Phone:

Receipt

No: 2193666

| | | |
|--|---|-----------------------------|
| Transaction #: 2263473 | | VIEWED INTO COMPUTER |
| Date of Transaction: 08/18/2010 | | AUG 25 2010 |
| CUSTOMER: | GREGORY RUSTIN PO BOX 63 ✓ LAUREL,MS 39441-0063 US <i>m</i> | |

| LINE # | QTY | DESCRIPTION | REMARKS | UNIT PRICE | TOTAL |
|---------------|------|---|--------------------------------|------------|-----------------|
| 1 | 1.00 | LOCATABLE MINERALS / MINING CLAIMS- NOT NEW-UNADJUD, ONE AUTH NO. ONLY / MINING CLAIM MONEY RECEIVED CASES: AMC366287/\$280.00 | MAINT FEE PYMNT (2) 2011 | - n/a - | 280.00 ✓ |
| TOTAL: | | | | | \$280.00 |

| PAYMENT INFORMATION | | | |
|---------------------|------------------|---|-----------------------------|
| 1 | AMOUNT: | 280.00 | POSTMARKED: N/A |
| | TYPE: | CHECK | RECEIVED: 08/18/2010 |
| | CHECK NO: | 14130042206 | |
| | NAME: | RUSTIN, GREGORY PO BOX 63 LAUREL MS 39441-0063 US | |

| |
|---------|
| REMARKS |
| |

This receipt was generated by the automated BLM Collections and Billing System and is a paper representation of a portion of the official electronic record contained therein.

AMC 366287

MAINTENANCE FEE PAYMENT

Claimant Name: Gregory Rustin
Address: Po Box 4031
City: Laurel State: MS Zip: 39441
Telephone: 601-319-9118 or 601-433-7507
E-mail address: rustinbuildings@aol.com
Signature: *Gregory Rustin*

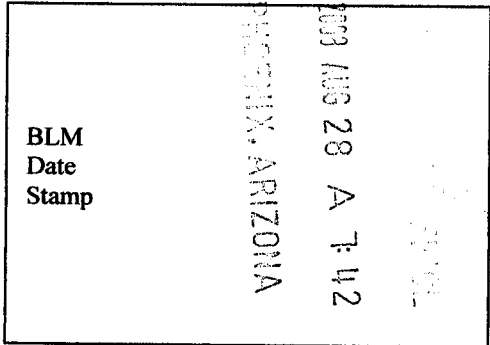

Check here if this is a change of address.

| LINE NO. | AMC NUMBER | CLAIM/SITE NAME | COUNTY RECORDER DATA (If available) | TWP | RNG | SEC |
|----------|------------|-----------------|-------------------------------------|-----|-----|----------|
| 1 | 366287 | GoldenRod #2 | | 9N | 4W | 7 NE 1/4 |
| 2 | | | | | | |
| 3 | | | | | | |
| 4 | | | | | | |
| 5 | | | | | | |
| 6 | | | | | | |
| 7 | | | | | | |
| 8 | | | | | | |
| 9 | | | | | | |
| 10 | | | | | | |

List additional claims on Form MCF114.

Bureau of Land Management
Arizona State Office
www.az.blm.gov

No. of Claims: 1 x \$125 125.00
 Check No: MO Init. SPB
 Receipt No.: 1776798
 For BLM Use Only

Form: MCF112
Revised July 2005

This form is available from the Arizona Department of Mines and Mineral Resources and may be reproduced.

ENTERED INTO COMPUTER

SEP 12 2008 PB

United States Department of the Interior

Bureau of Land Management
 BUSINESS & SUPPORT SVCS DIV
 ONE N CENTRAL AVE SUITE 800
 PHOENIX, AZ 85004 -4427
 Phone: (602) 417-9200

Receipt

No: 1776798

| | | |
|---------------------------------|---|------------------------------|
| Transaction #: 1834633 | | ENTERED INTO COMPUTER |
| Date of Transaction: 09/02/2008 | | |
| CUSTOMER: | GREGORY RUSTIN PO BOX 431 LAUREL,MS 39441 | SEP 12 2008 <i>PB</i> |

| LINE # | QTY | DESCRIPTION | REMARKS | UNIT PRICE | TOTAL |
|---------------|------|---|---------------|------------|-----------------|
| 1 | 1.00 | LOCATABLE MINERALS / MINING CLAIMS-NOT NEW-UNADJUD,ONE AUTH NO. ONLY / MINING CLAIM MONEY RECEIVED (455) CASES: AMC366287/\$125.00 | MAINT 2009 | - n/a - | 125.00 |
| TOTAL: | | | | | \$125.00 |

| PAYMENT INFORMATION | | | | | |
|---------------------|-----------|---|-------------|--------------|--|
| 1 | AMOUNT: | \$125.00 | POSTMARKED: | 8/26/08 0:00 | |
| | TYPE: | CHECK | RECEIVED: | 08/28/2008 | |
| | CHECK NO: | 08-933543130 | | | |
| | NAME: | RUSTIN, REGENIA PO BOX 4031 LAUREL MS 39441 | | | |

| |
|---------|
| REMARKS |
| |

This receipt was generated by the automated BLM Collections and Billing System and is a paper representation of a portion of the official electronic record contained therein.

Golden Rod Group LLC
PO Box 4031
Lumb MS 39441

HATTIESBURG MS 394

16 AUG 2006 PM 1 T

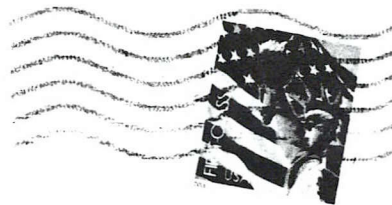

8-14-06
Please change the
mailing addresses on
both these claims to
PO Box 4031
Lumb MS 39441
AMC# 366287
+ AMC# 68554

Regina Kato
6014337507

United States Dept. of Interior
Bureau of Land Management
Business & Support Svcs Div.
222 N. Central Avenue
Phoenix AZ 85004 - 2203

5004+2203

PHOENIX, ARIZONA

2006 AUG 21 A 9:09

BLM
FIELD OFFICE

AMC 68526
AMC 366287

United States Department of the Interior
 Bureau of Land Management
 BUSINESS & SUPPORT SVCS DIV
 ONE N CENTRAL AVE
 PHOENIX, AZ 85004 -2203
 Phone: (602) 417-9200

Receipt

No: 1339312

| | |
|--|--|
| Transaction #: 1384489 | |
| Date of Transaction: 08/21/2006 | |
| CUSTOMER: | REGENIA M RUSTIN P.O. BOX 4031 89441 |

| LINE # | QTY | DESCRIPTION | REMARKS | UNIT PRICE | TOTAL |
|---------------|------|---|----------------|------------|-----------------|
| 1 | 1.00 | LOCATABLE MINERALS / MINING CLAIMS-NOT NEW-UNADJUD, ONE AUTH NO. ONLY / MINING CLAIM MONEY RECEIVED (455) CASES: AMC68554/\$250.00 | MAINT 2007 (2) | - n/a - | 250.00 |
| TOTAL: | | | | | \$250.00 |

| PAYMENT INFORMATION | | | |
|---------------------|-----------|---|------------------------|
| 1 | AMOUNT: | \$250.00 | POSTMARKED: 08/16/2006 |
| | TYPE: | CHECK | RECEIVED: 08/21/2006 |
| | CHECK NO: | 2203 | |
| | NAME: | RUSTIN, REGENIA M P.O. BOX 4031 89441 | |

| REMARKS |
|--|
| ATTENTION: PLEASE USE THE FORM OR AN 8 1/2 X 11 SHEET OF PAPER WHEN YOU FILE A DOCUMENT WITH US. |

This receipt was generated by the automated BLM Collections and Billing System and is a paper representation of a portion of the official electronic record contained therein.

pd for 2007 maint. fees

UNITED STATES
DEPARTMENT OF THE INTERIOR
BUREAU OF LAND MANAGEMENT

CREDIT CARD PAYMENT
FOR MINING CLAIM MAINTENANCE FEE

NAME Regenia Rustin
ADDRESS P. O. Box 4031
CITY Laurel STATE MS ZIP 39441
PHONE # (601) 433-7507

THIS IS A CHANGE OF ADDRESS

| AMC NUMBER | CLAIM/SITE NAME |
|---------------|----------------------|
| <u>366287</u> | <u>Golden Rod #2</u> |
| <u>68554</u> | <u>Golden Rod</u> |

DATE STAMP _____ COUNT 2 \$ 250 INITIALS TR

TELEPHONE SUBMISSION - ACCURACY OF THE ABOVE INFORMATION
IS THE RESPONSIBILITY OF THE CLAIMANT/OWNER

FOR OFFICIAL USE ONLY

PHOENIX, ARIZONA

DATE _____ INITIALS _____ VERIFIED _____

2006 AUG 23 A 10: 51

RECEIVED
B.L.M. AZ STATE OFFICE

1341680

**United States Department of the Interior
Bureau of Land Management
BUSINESS & SUPPORT SVCS DIV
ONE N CENTRAL AVE
PHOENIX, AZ 85004 -2203
Phone: (602) 417-9200**

Receipt

No: 1341680

| | |
|--|--|
| Transaction #: 1386899 | |
| Date of Transaction: 08/23/2006 | |
| CUSTOMER: | REGINA RUSTIN BOX 4031 LAUREL,MS 39441 |

| LINE # | QTY | DESCRIPTION | REMARKS | UNIT PRICE | TOTAL |
|---------------|------|--|-----------------|------------|-----------------|
| 1 | 1.00 | LOCATABLE MINERALS / MINING CLAIMS- NOT NEW-UNADJUD, ONE AUTH NO. ONLY / MINING CLAIM MONEY RECEIVED (455) CASES: AMC366287/\$250.00 | MAINT 2007/2 | - n/a - | 250.00 |
| TOTAL: | | | | | \$250.00 |

| PAYMENT INFORMATION | | | |
|--|---------------|---|----------------------|
| NOTE: Items will appear on credit card statement as "Bureau of Land Management". | | | |
| 1 | AMOUNT: | \$250.00 | POSTMARKED: N/A |
| | TYPE: | CREDIT CARD | RECEIVED: 08/23/2006 |
| | NAME: | RUSTIN, REGINA BOX 4031 LAUREL MS 39441 | |
| | CARD NO: | XXXXXXXXXXXX8737 | AUTH CODE: 055825 |
| | NAME ON CARD: | REGINA RUSTIN | |
| | EXPIRES: | 11/30/2006 | |
| | SIGNATURE: | | |

| |
|---------|
| REMARKS |
| |

This receipt was generated by the automated BLM Collections and Billing System and is a paper representation of a portion of the official electronic record contained therein.

2nd payment received - paid for 2008 maint. fees.

Amc 366287

Amc 68526

UNITED STATES
DEPARTMENT OF THE INTERIOR
BUREAU OF LAND MANAGEMENT

CREDIT CARD PAYMENT
FOR MINING CLAIM MAINTENANCE FEE

NAME Regenia Rustin

ADDRESS P. O. Box 4031

CITY Laurel STATE MS ZIP 39441

PHONE # (601) 433-7507

THIS IS A CHANGE OF ADDRESS

AMC NUMBER

CLAIM/SITE NAME

366287

Golden Rod #2

68554

Golden Rod

lead file # 68526

DATE STAMP

COUNT 2 \$ 250 INITIALS TR

TELEPHONE SUBMISSION - ACCURACY OF THE ABOVE INFORMATION
IS THE RESPONSIBILITY OF THE CLAIMANT/OWNER

FOR OFFICIAL USE ONLY

DATE

INITIALS

VERIFIED

PHOENIX, ARIZONA

2006 AUG 23 A 10: 57

RECEIVED
B.L.M. AZ STATE OFFICE

1341680

United States Department of the Interior
Bureau of Land Management
 BUSINESS & SUPPORT SVCS DIV
 ONE N CENTRAL AVE
 PHOENIX, AZ 85004 -2203
 Phone: (602) 417-9200

Receipt

No: 1341680

| | |
|---|------------------------------|
| Transaction #: 1386899 | ENTERED INTO COMPUTER |
| Date of Transaction: 08/23/2006 | AUG 28 2006 |
| CUSTOMER: REGINA RUSTIN BOX 4031 LAUREL,MS 39441 | |

| LINE # | QTY | DESCRIPTION | REMARKS | UNIT PRICE | TOTAL |
|---------------|------|--|-----------------|------------|-----------------|
| 1 | 1.00 | LOCATABLE MINERALS / MINING CLAIMS-NOT NEW-UNADJUD,ONE AUTH NO. ONLY / MINING CLAIM MONEY RECEIVED (455) CASES: AMC366287/\$250.00 | MAINT 2007/2 | - n/a - | 250.00 |
| TOTAL: | | | | | \$250.00 |

| PAYMENT INFORMATION | | | |
|--|---------------|---|----------------------|
| NOTE: Items will appear on credit card statement as "Bureau of Land Management". | | | |
| 1 | AMOUNT: | \$250.00 | POSTMARKED: N/A |
| | TYPE: | CREDIT CARD | RECEIVED: 08/23/2006 |
| | NAME: | RUSTIN, REGINA BOX 4031 LAUREL MS 39441 | |
| | CARD NO: | XXXXXXXXXXXX8737 | AUTH CODE: 055825 |
| | NAME ON CARD: | REGINA RUSTIN | |
| | EXPIRES: | 11/30/2006 | |
| | SIGNATURE: | | |

| REMARKS |
|---------|
| |

This receipt was generated by the automated BLM Collections and Billing System and is a paper representation of a portion of the official electronic record contained therein.

DEPARTMENT OF THE INTERIOR
BUREAU OF LAND MANAGEMENT
MINING CLAIMS
(LIVE) Serial Register Page

RunDate/Time: 08/28/06 09:50 AM

Page 1 of 2

01 10-21-1976;090STAT0090;43USC1744
Case Type 384201: PLACER CLAIM
Claim Name: GOLDEN ROD
Commodity :
Case Disposition: ACTIVE

Serial Number
AMC68554

| Name & Address | Int Rel | % Interest |
|--|----------|------------|
| BUCKLEY REGENIA M 2 TWIN OAKS PL LAUREL, MS 39440 | CLAIMANT | 0.000000C |
| RUSTIN BILL EDWARD 119 HARDY HODGE RD LAUREL, MS 39443 | CLAIMANT | 0.000000C |

| Mer Twp | Rng | Sec | Quadrant | District/Resource | County |
|---------|-------|-------|----------|-------------------|------------------------------------|
| 14 | 0090N | 0040W | 007 | NE | PHOENIX DISTRICT OFFICE YAVAPAI |

| Act Date | Code | Action | Action Remarks | Receipt Number |
|------------|------|-------------------------|-----------------------|----------------|
| 08/12/1931 | 403 | LOCATION DATE | | |
| 10/01/1979 | 395 | RECORDATION NOTICE RECD | | |
| 08/26/2005 | 485 | MULTIPLE PAYMENT | 582;2006 | 1141494 |
| 07/13/2004 | 485 | MULTIPLE PAYMENT | 582;2005 | 909813 |
| 08/08/2001 | 488 | ASSMT DOC RECEIVED | 480;2001 | 352504 |
| 08/11/2006 | 582 | MAINTENANCE FEE/\$125 | 2007 | 1332248 |
| 08/04/2005 | 582 | MAINTENANCE FEE/\$125 | 2006 | 1121817 |
| 08/17/2004 | 582 | MAINTENANCE FEE/\$125 | 2005 | 929905 |
| 08/20/2003 | 482 | MAINTENANCE FEE/\$100 | 2004 | 734333 |
| 08/16/2002 | 482 | MAINTENANCE FEE/\$100 | 2003 | 544136 |
| 08/08/2001 | 482 | MAINTENANCE FEE/\$100 | 2002 | 352504 |
| 08/29/2000 | 482 | MAINTENANCE FEE/\$100 | 2001 | 178823 |
| 08/27/1999 | 482 | MAINTENANCE FEE/\$100 | 2000 | |
| 08/28/1998 | 482 | MAINTENANCE FEE/\$100 | 1999 | |
| 08/26/1997 | 482 | MAINTENANCE FEE/\$100 | 1998 | |
| 08/21/1996 | 482 | MAINTENANCE FEE/\$100 | 1997 | |
| 08/28/1995 | 482 | MAINTENANCE FEE/\$100 | 1996 | |
| 08/03/1994 | 482 | MAINTENANCE FEE/\$100 | 1995 | |
| 08/25/1993 | 482 | MAINTENANCE FEE/\$100 | 1994 | |
| 08/25/1993 | 482 | MAINTENANCE FEE/\$100 | 1993;RECEIPT 2044551 | |
| 07/27/1992 | 480 | EVID OF ASSMT FILED | 1992 | |
| 08/21/2006 | 392 | MONIES RECEIVED | \$250.00;1 | 1339312 |
| 04/28/2004 | 396 | TRF OF INTEREST FILED | RUSTIN GREGORY D | 878912 |
| 04/15/2004 | 396 | TRF OF INTEREST FILED | AZ ASSOC OF MINING DI | 866437 |
| 08/03/2001 | 396 | TRF OF INTEREST FILED | THOMASON CLYDE | 352431 |
| 10/06/1988 | 669 | LAND STATUS CHECKED | | |
| 01/23/1985 | 396 | TRF OF INTEREST FILED | AMERICAN PLACER | |
| 12/20/1983 | 396 | TRF OF INTEREST FILED | GRUBSTAKER | |
| 12/15/1980 | 635 | AMENDED LOCATION FILED | | |
| 10/01/1979 | 500 | MAP IN LEAD FILE | AMC68526; | |
| 10/01/1979 | 501 | ACCT ADV IN LEAD FILE | AMC68526; | |

Authorized Date 01/24/2006

Instructions to Accounts AZ BLM REFUND \$40 TO GOLDENROD GROUP LLC FOR
OVERPAYMENT OF 2006 MAINTENANCE FEES FOR AMC366287
RECEIPT #1141494 AB

Login ID 2393

Entry Date 01/24/2006

Total Amount \$40.00

Amc 366287
Amc 68526

Amc 366287
Amc 68526

United States Department of the Interior
Bureau of Land Management
BUSINESS & SUPPORT SVCS DIV
ONE N CENTRAL AVE
PHOENIX, AZ 85004 -2203
Phone: (602) 417-9200

Receipt

No: 1141494

| | |
|--|---|
| Transaction #: 1180731 | |
| Date of Transaction: 08/30/2005 | |
| CUSTOMER: | GOLDENROD GROUP LLC #2 TWIN OAKS PL LAUREL,MS 39440 |

| LINE # | QTY | DESCRIPTION | REMARKS | UNIT PRICE | TOTAL |
|---------------|------|---|---|------------|---|
| 1 | 1.00 | LOCATABLE MINERALS / MINING CLAIMS-NOT NEW-UNADJUD, ONE AUTH NO. ONLY / MINING CLAIM MONEY RECEIVED (455) CASES: AMC68554/\$125.00 | MAINT 2006 (1) <i>Amc 366287</i> | - n/a - | 125.00 |
| 2 | 1.00 | OVERPAYMENT / OVERPAYMENT OF FEES / OVERPAYMENT OF MORE THAN \$1 (455) | AZA 033132, - GOLDEN ROD #2? <i>overpayment</i> | - n/a - | 125 165.00 40 |
| TOTAL: | | | | | \$290.00 |

| PAYMENT INFORMATION | | | |
|---------------------|-----------|---|------------------------|
| 1 | AMOUNT: | \$290.00 | POSTMARKED: 08/24/2005 |
| | TYPE: | CHECK | RECEIVED: 08/26/2005 |
| | CHECK NO: | 1083 | |
| | NAME: | GOLDENROD GROUP LLC #2 TWIN OAKS PL LAUREL MS 39440 | |

| REMARKS |
|------------------|
| REC'D CHECK ONLY |

This receipt was generated by the automated BLM Collections and Billing System and is a paper representation of a portion of the official electronic record contained therein.

Refunded \$40 overpayment

NOTICE!!

These documents have been scanned!

Do not place un-scanned documents beneath this notice!

Do not remove this notice from this file!

GPO Jacket No. 560-102
Print Order 61540
Rise Business Services, LLC
Job=AZ15 6/5/2019



Box Number= AZ15114



Claim Begin-End: AMC366287-AMC366287

5 Miscellaneous



AZ15114-11

AMC365609-AMC366287

Authorized Date 10/08/2015

Instructions to Accounts AZ BLM REFUND \$1860.00 TO GOLDENROD GROUP LLC FOR
OVERPAYMENT ON AMC366287 RECEIPT #3376036. IR

Login ID 6771

Entry Date 10/05/2015

Total Amount \$1,860.00

NOTICE!!

These documents have been scanned!

Do not place un-scanned documents beneath this notice!

Do not remove this notice from this file!

GPO Jacket No. 560-102
Print Order 61540
Rise Business Services, LLC
Job=AZ15 6/5/2019



Box Number= AZ15114



Claim Begin-End: AMC366287-AMC366287

6 Location Notices-Amendments and Supporting Documents



AZ15114-11

AMC365609-AMC366287

MINING CLAIM STATUS REPORT

STATUS:

MTP CHECKED BY TR

GEO CHECKED BY TR

PRE-ADJ BY _____

FINAL ADJ BY W. M. [unclear] 1/25/06

LEAD SERIAL NO. AMC 366287 THROUGH AMC _____

| | | | |
|------------|----------------|---------------------------|---------------|
| # _____ | LODE | LOCATION FEE @ \$25 = | \$ <u>25</u> |
| # _____ | PLACER | SERVICE FEE @ \$10 = | \$ <u>10</u> |
| # <u>1</u> | ASSOCIATION PL | MAINTENANCE FEE @ \$100 = | \$ <u>100</u> |
| # _____ | MILL SITE | OVERAGE | \$ _____ |
| # _____ | TUNNEL SITE | SHORTAGE | \$ _____ |
| | | OTHER FEES | \$ _____ |
| | | TOTAL | \$ <u>135</u> |

OVER-THE-COUNTER MAIL TIMELY FILED: YES NO

LEGAL DESCRIPTION: T 9N R 4W SEC 7
T _____ R _____ SEC _____
T _____ R _____ SEC _____
T _____ R _____ SEC _____

JURISDICTION: BLM FOREST SERVICE

WILDERNESS AREA: NO YES

SPLIT ESTATE: SX PX SRHA OTHER N/A
PROPER NOTICE FILED IF LOCATED ON SRHA LANDS: YES NO N/A

RECONVEYED MINERALS ON BLM LANDS REQUIRE OPENING ORDERS FROM 1944 TO 1993. OPEN TO ENTRY ON: _____

SUBJECT TO PL 359: YES NO

STATUS; VOID PARTIALLY VOID PRIVATE MINERALS
WITHDRAWN LANDS OTHER

CLAIMANT ACKNOWLEDGES THAT PORTIONS OF THE FOLLOWING CLAIM(S)/SITE(S): _____
MAY BE VOID OR VOIDABLE. Signature of Claimant: _____

COMMENTS: _____
_____ Final Adj. TR
5-2-05

FEE
\$5
\$8
\$5
\$1
\$14

When Recorded Mail To:



B-4279 P-482
Page: 1 of 2
NML 3876155

Name: **Golden Rod Group LLC**
Address: **2 Twin Oaks Place**
City/ State / Zip Code: **Laurel, MS 39440**

LOCATION NOTICE FOR PLACER MINING CLAIM

NOTICE IS HEREBY GIVEN that the **Golden Rod #2** placer mining claim has been located by **Gregory Don Rustin, Bill Edwin Rustin, Daniel Rustin, Amy Upshaw, James Hall, James Crane, Janice Rosser, Brent Rustin**, whose current mailing address is **2 Twin Oaks Place, Laurel MS 39440**.

The general course of this claim is **North to South** and it is situated in **Yavapai** County, Arizona.

This claim is **2640** feet in length and **2640** feet in width. This claim runs from the location monument on which this location notice is posted approximately **1320** feet in a

Westerly direction to the **West** end line and **1320** feet in a **Easterly** direction to the **East** end line. This claim is marked by four monuments, one at each corner of the claim.

The location monument on which this notice is posted is situated within Section **7 NE ¼**, Township **9 North**, Range **4 West**, Gila Salt River Base and Meridian, Arizona. This claim encompasses portions of the following legal subdivisions (s) if located by legal subdivisions) or the following quarter section (s), section (s), Township (s) and Range (s)

NE ¼, Section 7, Township 9 North, Range 4 West

Gila Salt River Base and Meridian, Arizona.

The locality of this claim with reference to some natural object or permanent monument and additional information (if any) concerning its locality are as follows: **The North East Corner of the claim is situated at corner marker of Sections 5, 6, 7, & 8, of Township 9 North Range 4 West. Then proceeding 1320 ft west to location monument.**

DATED AND POSTED on the ground this **21st** day of **June, 2005**.

| <u>LOCATOR (s)</u> | <u>Address</u> |
|--------------------|--|
| Gregory Don Rustin | P.O. Box 4031, Laurel, MS 39441 |
| Bill Edwin Rustin | 186 Jordan Drive, Laurel, MS 39443 |
| Daniel Rustin | P.O. Box 63, Laurel, MS 39441 |
| Amy Upshaw | 92 Jeff Byrd Road, Laurel, MS 39443 |
| James Hall | P.O. Box 841, Bay Springs, MS 39422 |
| James Crane | P.O. Box 84, Soso, MS 39480 |
| Janice Rosser | 1204 Holly Drive, Ellisville, MS 39437 |
| Brent Rustin | 9 Twin Oaks Place, Laurel, MS 39440 |

Gregory Don Rustin
Bill Edwin Rustin
Daniel Rustin
Amy Upshaw
James Hall
James Crane
Janice Rosser
Brent Rustin

RECEIVED
B.L.M. AZ STATE OFFICE
2005 JUN 21 P 2:41
PHOENIX, ARIZONA

AMC 366287



CLAIM MAP

Lode () Placer (X)

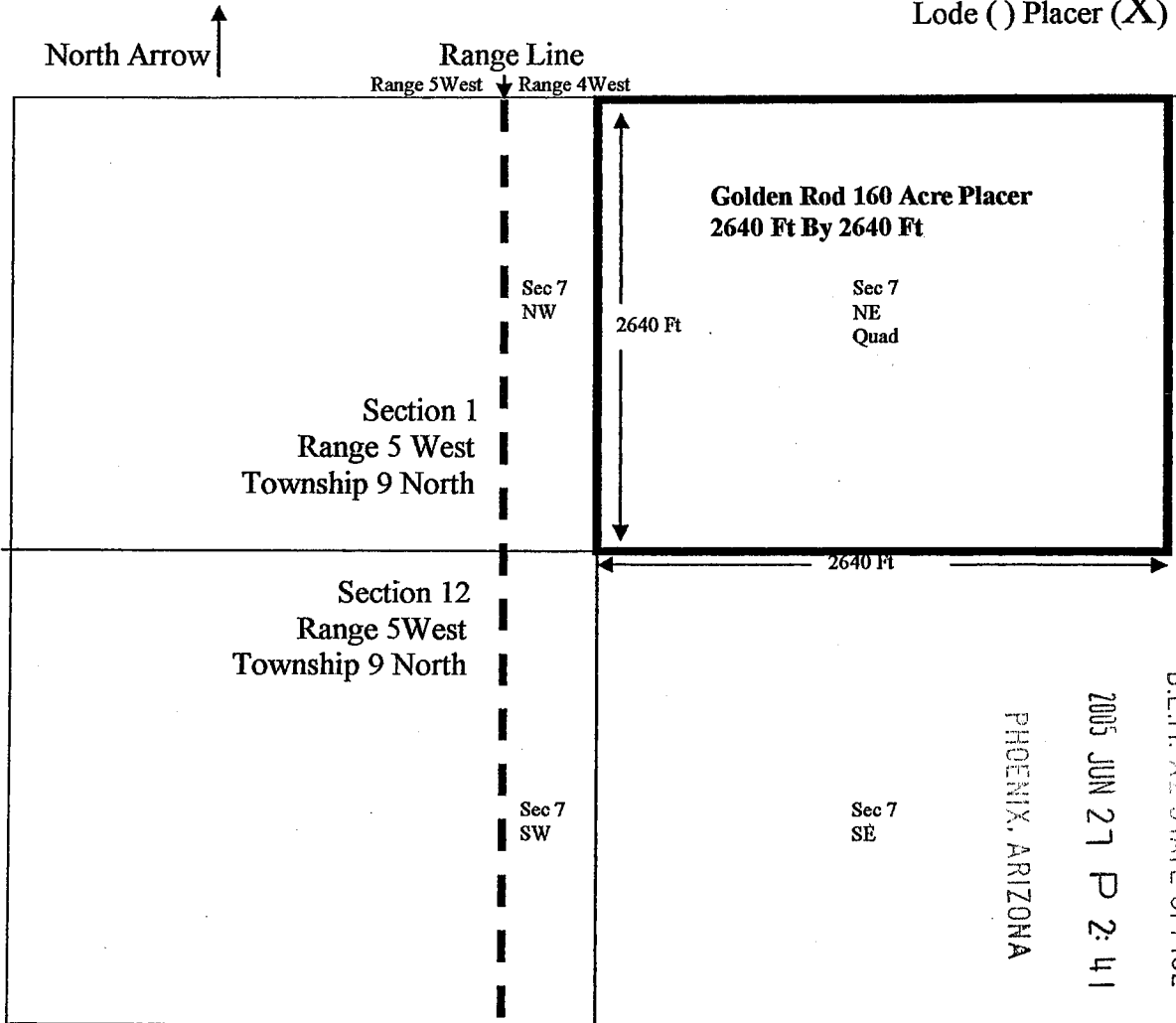

AMC 366281

Date : **June 21, 2005**

1. The above map depicts the **Golden Rod #2** mining claim, which is located in Section (s) **7 NE 1/4 Township 9 North**, Range **4 West**, Gila and Salt River Base and Meridian, **Yavapai** County, Arizona.
2. The type of corner and location monuments used are as follows: **4" x 4" x 6 foot wood posts**
3. The bearings and distances in degrees and feet between claim corners are as depicted on the map.

Input Parameters for Geographic Report with Land

System Id = CR

Admin State = AZ

Geo State =

Casetype begins with

Case Disp Txt = AUTHORIZED, CANCELLED, EXPIRED, No Match, PENDING, REJECTED, RELINQUISHED, VOID, WITHDRAWN

Mer Twp Rng =

Mtrs = 14 0090N 0040W 007

Commodity =

Pending Org =

Section =

Total Rows Returned: 5

RUN TIME: 02:39 PM

UNITED STATES DEPARTMENT OF INTERIOR
BUREAU OF LAND MANAGEMENT
GEOGRAPHIC REPORT WITH LAND
Sorted by Serial Number

RUN DATE: 06/27/2005
Page 1 of 1

Adm State: AZ

Serial Number: AZA 029027
Total Case Acres: 1.000

| <u>Casetype</u> | <u>Case Disp</u> | 14 | 0090N | 0040W | <u>Sect</u> | <u>Sur Typ</u> | <u>Sur Num</u> | <u>Suff</u> | <u>Subdivision</u> | <u>Act Pend</u> |
|-----------------|------------------|----|-------|-------|-------------|----------------|----------------|-------------|--------------------|-----------------|
| 380913 | EXPIRED | | | | 007 | FF | | 1 | ALL | |

Serial Number: AZA 031568
Total Case Acres: 1.000

| <u>Casetype</u> | <u>Case Disp</u> | 14 | 0090N | 0040W | <u>Sect</u> | <u>Sur Typ</u> | <u>Sur Num</u> | <u>Suff</u> | <u>Subdivision</u> | <u>Act Pend</u> |
|-----------------|------------------|----|-------|-------|-------------|----------------|----------------|-------------|--------------------|-----------------|
| 837000 | AUTHORIZED | | | | 007 | FF | | | PORTION OF; | |

Serial Number: AZA 033132
Total Case Acres: 5.000

| <u>Casetype</u> | <u>Case Disp</u> | 14 | 0090N | 0040W | <u>Sect</u> | <u>Sur Typ</u> | <u>Sur Num</u> | <u>Suff</u> | <u>Subdivision</u> | <u>Act Pend</u> |
|-----------------|------------------|----|-------|-------|-------------|----------------|----------------|-------------|--------------------|-----------------|
| 380913 | PENDING | | | | 007 | FF | | | NE; | Y |

Serial Number: AZAR 0000110
Total Case Acres: 16.660

| <u>Casetype</u> | <u>Case Disp</u> | 14 | 0090N | 0040W | <u>Sect</u> | <u>Sur Typ</u> | <u>Sur Num</u> | <u>Suff</u> | <u>Subdivision</u> | <u>Act Pend</u> |
|-----------------|------------------|----|-------|-------|-------------|----------------|----------------|-------------|--------------------|-----------------|
| 285003 | AUTHORIZED | | | | 007 | ALIQ LOTS | | | W2E2; 2,3,4; | |

TOWNSHIP 9 NORTH RANGE 4 WEST OF THE GILA AND SALT RIVER MERIDIAN, ARIZONA

YAVAPAI COUNTY

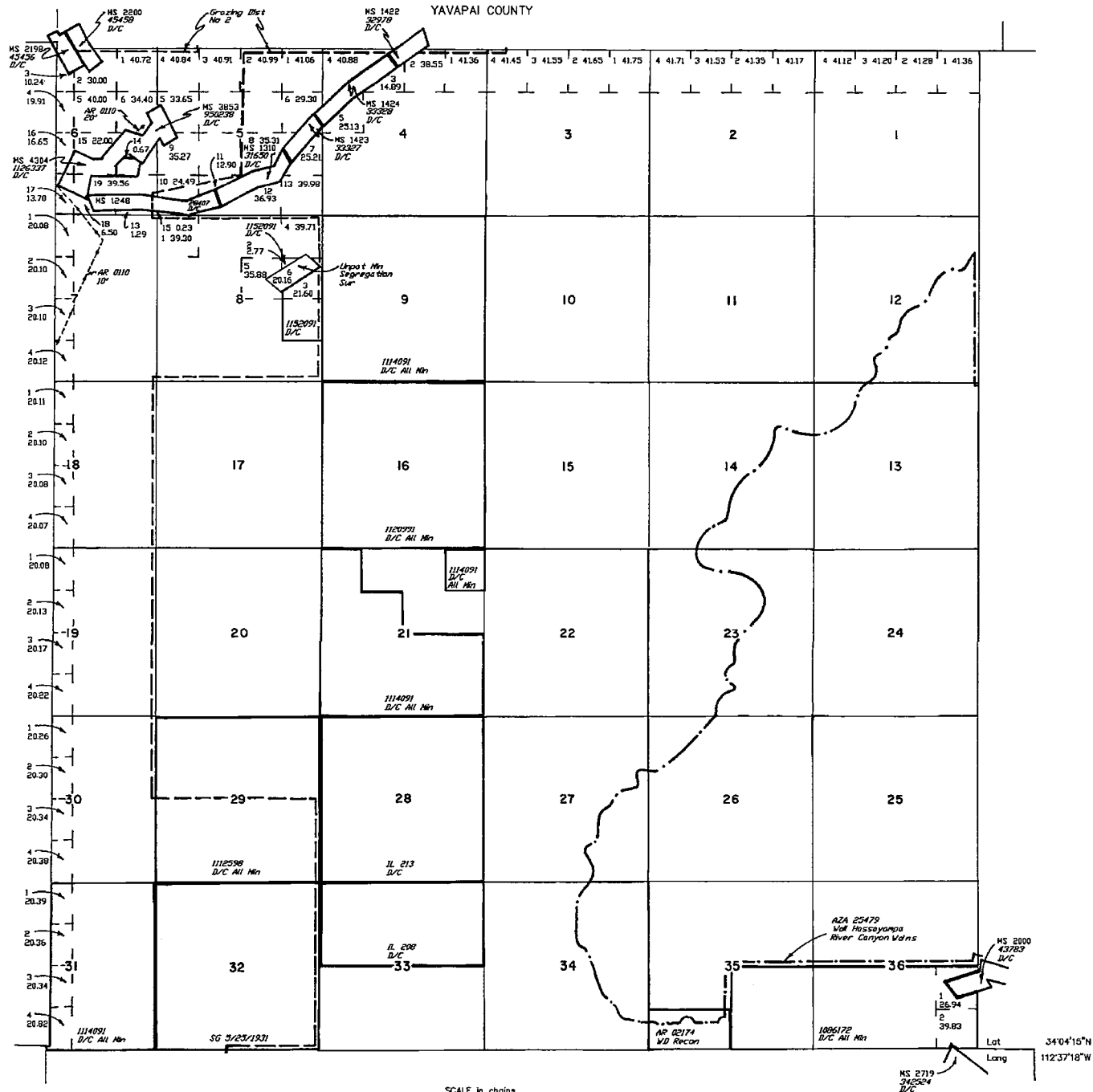

| INDEX TO SEGREGATED TRACTS | | | | |
|----------------------------|-----------------|---|-----|-------------|
| RESURVEY TRACT NO | ORIGINAL SURVEY | | | |
| | T | R | SEC | SUBDIVISION |
| | | | | |
| | | | | |
| | | | | |
| | | | | |
| | | | | |
| | | | | |
| | | | | |
| | | | | |
| | | | | |
| | | | | |
| | | | | |
| | | | | |
| | | | | |
| | | | | |
| | | | | |
| | | | | |
| | | | | |
| | | | | |
| | | | | |

FOR ORDERS AFFECTING DISPOSAL OR USE OF UNIDENTIFIED LANDS WITHDRAWN FOR CLASSIFICATION, MINERALS, WATER AND/OR OTHER PUBLIC PURPOSES, REFER TO INDEX OF MISCELLANEOUS DOCUMENTS.

DIST NO 2
MDS 286 NW

Pending Resurvey Secs 4, 5, 6, 7, 8, 21, 33, 35 & 36 under Group No 811 dated 1/3/1979

A 12828 Rest to MC Appl
Sec 29 : E1/2
Sec 33 : S1/2
Sec 34 : All
Sec 35 : N1/2, SW1/4
Sec 36 : N1/2

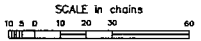

WARNING STATEMENT
This plot is the Bureau's Record of Title, and should be used only as a graphic display of the township survey data. Records herein do not reflect title changes which may have been effected by lateral movements of rivers or other bodies of water. Refer to the original surveys for official survey information.

| CURRENT TO | GS | T | R |
|------------|----|-----|-----|
| 6-30-2003 | PV | 9 N | 4 W |